

## It's All About Choice

Wood • Finish • Hardware

### Hardware Options

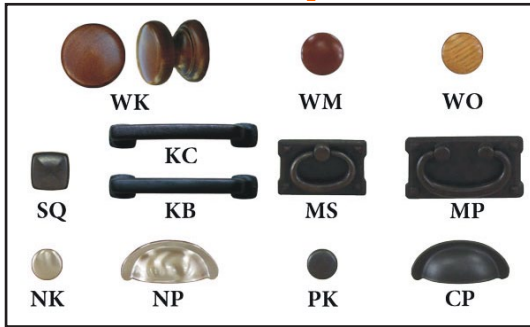

### Fine Woods

Maple  
Oak

### Select Finish



All Stuart David products have a multi-step finish. A multi-step finish involves sanding, staining, shading, glazing, and polishing - just to name a few. You can see and feel the protective beauty and choice of many rich colors.

### Night Stands, Dressers, & Chests



Maple ARC  
K1-N02  
**Bed Side Stand**  
21w 19d 28¾h



K1-B02  
**Night Stand**  
23w 19d 25h



Maple 302  
K1-B01  
**Night Stand**  
26w 19d 26¾h



K1-B03  
**Night Stand**  
16½w 19d 29½h



K1-B89  
**Small Dresser**  
36w 19d 36h



Maple 02  
K1-B90  
**43" Dresser / Chest**  
45w 19d 36h



Maple 02  
K1-B91  
**49" Dresser / Chest**  
51w 19d 36h



Maple 02  
K1-B92  
**58" Dresser / Chest**  
60w 19d 36h

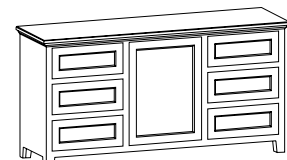

K1-B95  
**Dresser**  
65½w 19d 36h



Maple 302  
K1-B93  
**49" Dresser / Chest**  
51w 19d 48h



Maple 302  
K1-B94  
**58" Dresser / Chest**  
60w 19d 48h

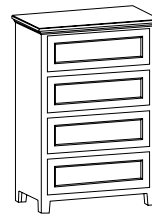

K1-B80  
**Chest**  
38w 19d 48h



Maple 06  
K1-M01  
**Mirror**  
31½w 1½d 40h

### Bunching Chests & Upper



Maple ABP  
K1-W29(O)  
**Bunching Chest**  
28½w 16½d 26h



Maple ABP  
K1-W29(D)  
**Bunching Chest**  
28½w 16½d 26h



Maple ABP  
K1-W29(R)  
**Bunching Chest**  
28½w 16½d 26h

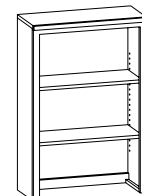

K1-WU29  
**Bunching Upper**  
28½w 13d 44h

no particle board

## Bunching Chests

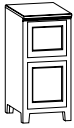

K1-W614  
**Bunching Chest**  
14½w 22d 29½h

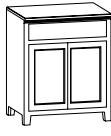

K1-W630D  
**Bunching Chest**  
30w 19d 29½h



K1-W630  
**Bunching Chest**  
30w 19d 29½h



K1-W643  
**Bunching Chest**  
43w 19d 29½h

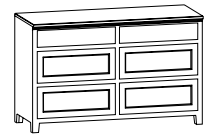

K1-W658  
**Bunching Chest**  
58w 19d 29½h

## Student Desks & Uppers



Maple AHP  
K1L-WD43  
**Student Desk**  
43w 22d 29½h



Maple AHP  
K1R-WD43  
**Student Desk**  
43w 22d 29½h

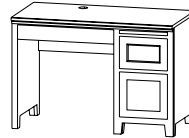

K1L-WD43K  
**Student Desk**  
43w 22d 29½h

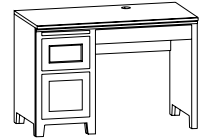

K1R-WD43K  
**Student Desk**  
43w 22d 29½h



Maple 02  
K1-WD58  
**Student Desk**  
58w 22d 29½h



Maple 06  
K1-WD58K  
**Student Desk with Keyboard Tray**  
58w 22d 29½h

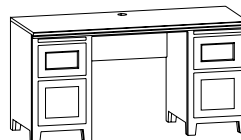

K1-WR58  
**Student Desk**  
58w 22d 29½h

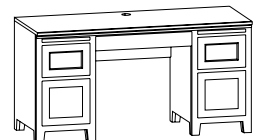

K1-WR58K  
**Student Desk with Keyboard Tray**  
58w 22d 29½h

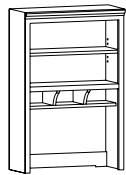

K1-WU30  
**30" Hutch**  
30w 13¼d 45½h

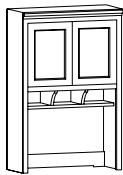

K1-WU30D  
**30" Hutch**  
30w 13¼d 45½h



K1-WU43  
**43" Hutch**  
43w 13¼d 45½h

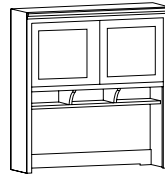

K1-WU43D  
**43" Hutch**  
43w 13¼d 45½h

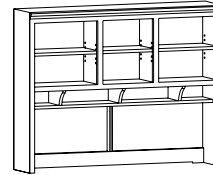

K1-WU58  
**58" Hutch**  
58w 13¼d 45½h

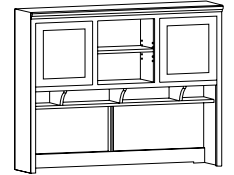

K1-WU58D  
**58" Hutch**  
58w 13¼d 45½h

## Complete Corner Desks

25" Wide Leg Space

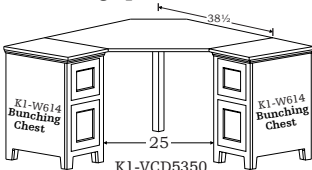

With Lap Drawer  
K1-VCD5351

30" Wide Leg Space

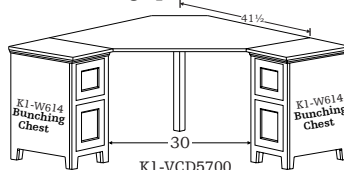

With Lap Drawer  
K1-VCD5701

## Corner Unit Only

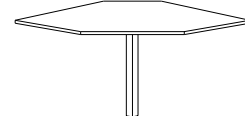

25" Wide Leg Space  
K1-CT25  
(As shown)  
With Lap Drawer  
K1-CT251

30" Wide Leg Space  
K1-CT30  
(As shown)  
With Lap Drawer  
K1-CT301

## Media Stands, Bookcase & Hutch



Maple 304



Maple 304  
**Hutch for Bookcase Tower**  
K1-TH43: 43w 15d 15¼h  
K1-TH49: 49w 15d 15¼h  
K1-TH58: 58w 15d 15¼h

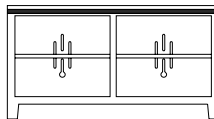

**Media Stand Open**  
KE-M143(O): 43w 21d 23h  
KE-M149(O): 49w 21d 23h  
KE-M158(O): 58w 21d 23h

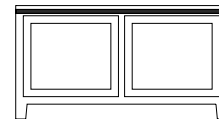

**Media Stand with Wood Doors**  
KE-M143(D): 43w 21d 23h  
KE-M149(D): 49w 21d 23h  
KE-M158(D): 58w 21d 23h



Maple 304  
**Media Stand with Glass Doors**  
KE-M143(G): 43w 21d 23h  
KE-M149(G): 49w 21d 23h  
KE-M158(G): 58w 21d 23h

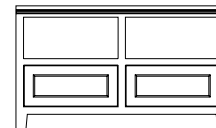

**Media Stand with Drawers**  
KE-M243(D): 43w 19¼d 25¼h  
KE-M249(D): 49w 19¼d 25¼h  
KE-M258(D): 58w 19¼d 25¼h



Oak 300  
**Bookcase Tower**  
K1-T69: 24w 15d 68½h  
K1-T78: 24w 15d 78h

## Miscellaneous Items



Oak WY  
K1-N28  
**Blanket Chest**  
36w 18d 18h



K1-N20  
**Small Bench**  
28w 12d 20½h



Maple 307  
K1-N21  
**Large Bench**  
36½w 16d 20½h

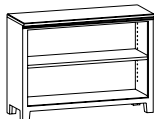

K1-N22  
**Bookcase**  
42w 15d 30½h

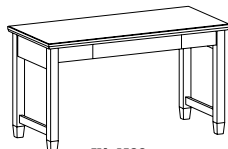

K1-N29  
**Desk Table**  
53w 24d 30h

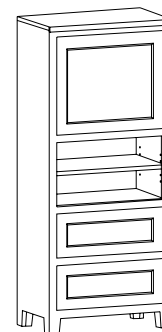

K1-N25  
**Modular Tower**  
24½w 15¼d 58½h

## Bridge Desk & Media Hutches



K1-9FD10  
**Bridge Desk**  
49w 22½d 5¼h



Maple 302  
**Media Hutch Single High**  
K1-9B43: 43w 16½d 15¼h  
K1-9B49: 49w 16½d 15¼h  
K1-9B58: 58w 16½d 15¼h

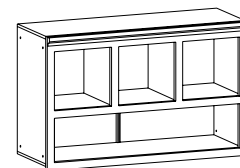

**Media Hutch Double High**  
K1-9B43T: 43w 16½d 27h  
K1-9B49T: 49w 16½d 27h  
K1-9B58T: 58w 16½d 27h

## Storage Towers

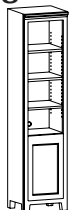

K1-B118(OD)  
**Storage Tower**  
17½w 16¼d 75h

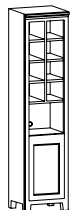

K1-B118(CD)  
**Storage Tower**  
17½w 16¼d 75h

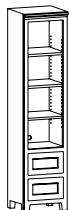

K1-B118(OR)  
**Storage Tower**  
17½w 16¼d 75h

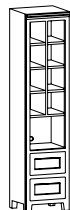

K1-B118(CR)  
**Storage Tower**  
17½w 16¼d 75h



Maple 302  
K1-B218(OD)  
**Storage Tower**  
17½w 16¼d 75h



Maple 302  
K1-B218(CD)  
**Storage Tower**  
17½w 16¼d 75h

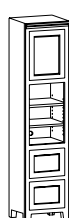

K1-B218(OR)  
**Storage Tower**  
17½d 16¼d 75h

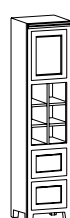

K1-B218(CR)  
**Storage Tower**  
17½w 16¼d 75h

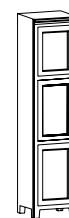

K1-B218(DD)  
**Storage Tower**  
17½w 16¼d 75h



K1-B218(DR)  
**Storage Tower**  
17½w 16¼d 75h

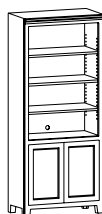

K1-B132(OD)  
**Storage Tower**  
31½w 16¼d 75h

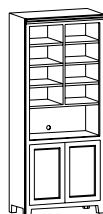

K1-B132(CD)  
**Storage Tower**  
31½w 16¼d 75h

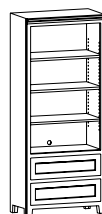

K1-B132(OR)  
**Storage Tower**  
31½w 16¼d 75h

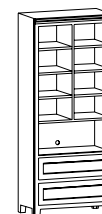

K1-B132(CR)  
**Storage Tower**  
31½w 16¼d 75h

## Corner Storage Towers

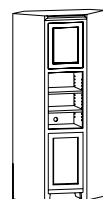
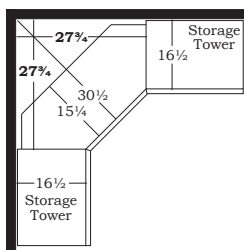

K1-CB218(O)  
**Corner Storage Tower**  
75h

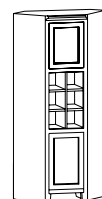

K1-CB218(C)  
**Corner Storage Tower**  
75h



Maple 302  
K1-CB218(D)  
**Corner Storage Tower**  
75h

no particle board

## Lounge Bed & Stacking Chests



Maple ABP  
Twin K1-LG04T: 59w 79¼d 26h  
Full K1-LG04F: 74w 79¼d 26h  
Queen K1-LG04Q: 80w 84¼d 26h



Maple ABP  
**Lounge Stacking Chest**  
Twin & Full K1-LK4S(O): 79w 16d 20h  
Queen K1-LK4X(O): 84w 16d 20h

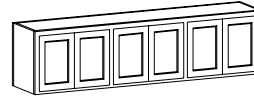

Maple ABP  
**Lounge Stacking Chest**  
Twin & Full K1-LK4S(D): 79w 16d 20h  
Queen K1-LK4X(D): 84w 16d 20h



Maple ABP  
**Lounge Stacking Chest**  
Twin & Full K1-LK4S(R): 79w 16d 20h  
Queen K1-LK4X(R): 84w 16d 20h

## Beds

### Tommy Bed

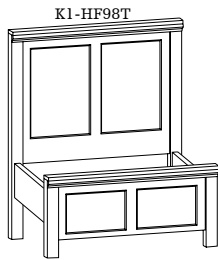

Available Bed Sizes  
Twin

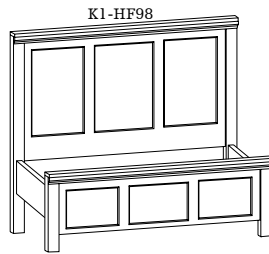

Available Bed Sizes  
Full, Queen, Eastern King & Western King

Heights for Beds with Rails or Single High Platforms  
Headboard Height 49"  
Footboard Height 18¾"

Headboard Height 49"  
Footboard Height 18¾"

### Valley View Bed

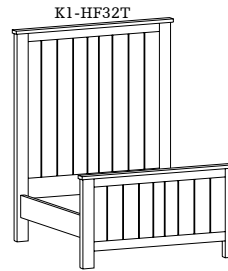

Available Bed Sizes  
Twin

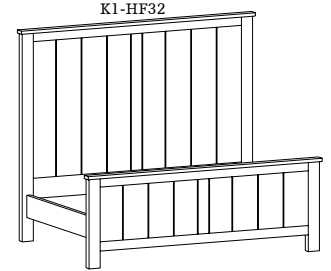

Available Bed Sizes  
Full, Queen, Eastern King & Western King

Heights for Beds with Rails or Single High Platforms  
Headboard Height 52"  
Footboard Height 22¾"

Headboard Height 52"  
Footboard Height 22¾"

### Double High Tommy Bed

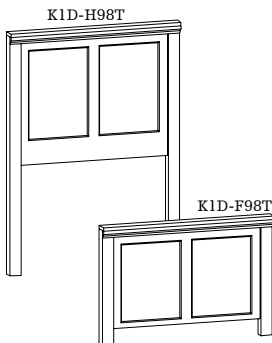

Available Bed Sizes  
Twin

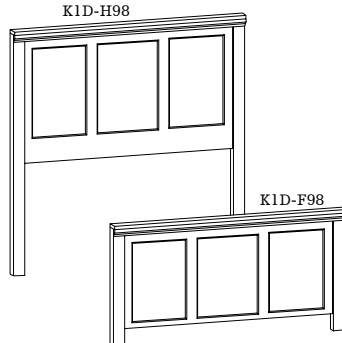

Available Bed Sizes  
Full, Queen, Eastern King & Western King

Heights for Beds with Double High Platforms  
Headboard Height 58"  
Footboard Height 27¾"

Headboard Height 58"  
Footboard Height 27¾"

### Double High Valley View Bed

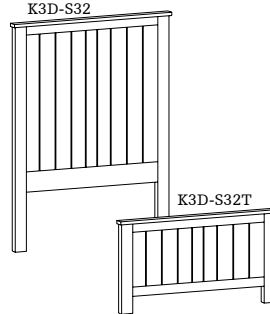

Available Bed Sizes  
Twin

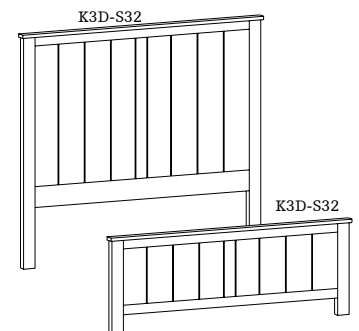

Available Bed Sizes  
Full, Queen, Eastern King & Western King

Heights for Beds with Double High Platforms  
Headboard Height 61"  
Footboard Height 31¾"

Headboard Height 61"  
Footboard Height 31¾"

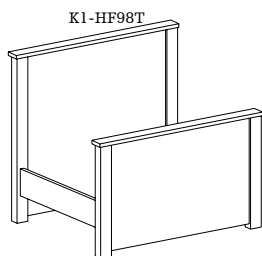

Headboard Height 49"  
Footboard Height 18¾"

Available Bed Sizes  
Twin

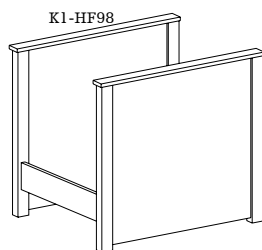

Headboard Height 49"  
Footboard Height 18¾"

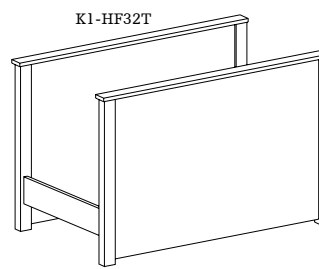

Headboard Height 52"  
Footboard Height 22¾"

Available Bed Sizes  
Full, Queen, Eastern King & Western King

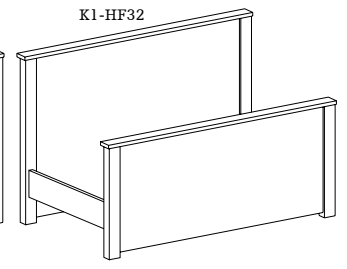

Headboard Height 52"  
Footboard Height 22¾"

### Trundle Bed



K1-910  
**Twin Trundle**  
41½w 77d 17h

Oak 3CO

## Single High Bookcase Headboards

*Bookcase Headboard*

K1-BD05

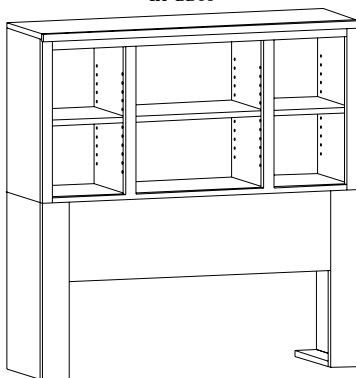

Headboard Height 49"

Headboards Available for  
Twin, Full, Queen, Eastern King & Western King

*Bookcase Headboard with Storage both Sides*

K1-BD07



Maple 06

Headboard Height 49"

## Bookcases Uppers



Oak 3CO

Upper Height 28 3/4"

K1-BDU3T - Twin

K1-BDU3F - Full

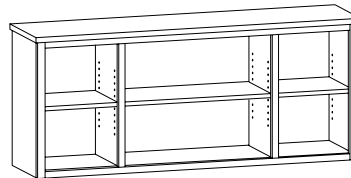

Upper Height 28 3/4"

K1-BDU3Q - Queen

K1-BDU3E - Eastern King

K1-BDU3W - Western King

## Double High Bookcase Headboards

*Bookcase Headboard*

K1-BD06

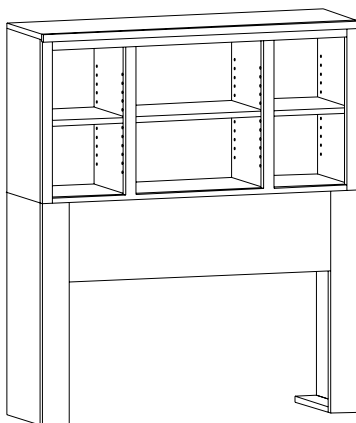

Headboard Height 58"

Headboards Available for  
Twin, Full, Queen, Eastern King & Western King

*Bookcase Headboard with Storage both Sides*

K1-BD08



Maple 06

Headboard Height 58"

## Storage Platform



Maple AHP

**Storage Platform**

Twin: 77w 41 1/2d 15 1/2h

Full: 77w 56 1/2d 15 1/2h

Queen: 82w 62 1/2d 15 1/2h

no particle board

## Single High Platform Beds

### 4 Door Platform

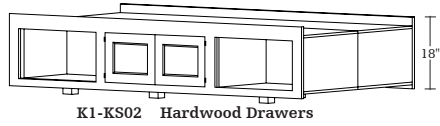

### 2 Door Platform

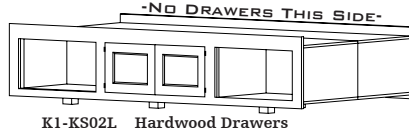

### 2 Door Platform

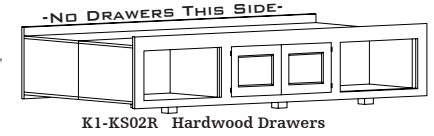

Available Bed Sizes  
Twin, Full, Queen, Eastern King & Western King

### 4 Drawer Platform

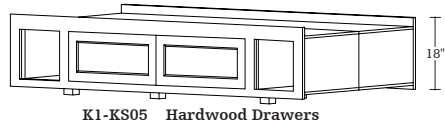

### 2 Drawer Platform

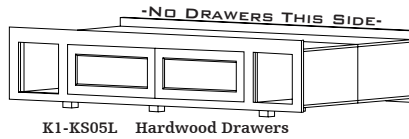

### 2 Drawer Platform

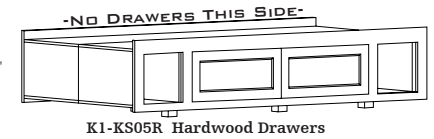

Available Bed Sizes  
Twin, Full, Queen, Eastern King & Western King

### 4 Drawer Platform

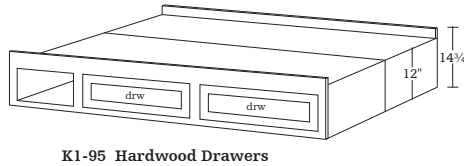

### 2 Drawer Platform

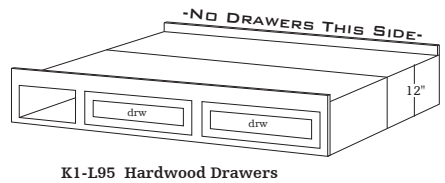

### 2 Drawer Platform

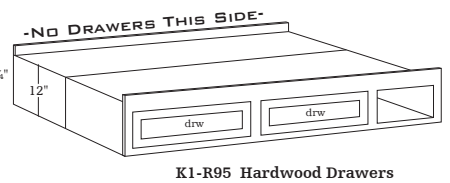

Available Bed Sizes  
Twin, Full, Queen, Eastern King & Western King

## Single High Platform Footboards

### Plain Footboard

29P-FT

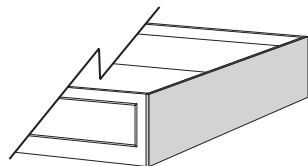

### Paneled Footboard

29-FT

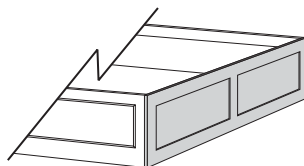

## Double High Platform Footboards

### Plain Footboard

29DP-FT

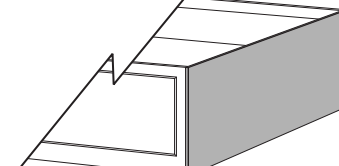

### Paneled Footboard

29D-FT

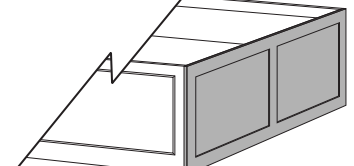

## Double High Platform Beds

### 8 Drawer Platform

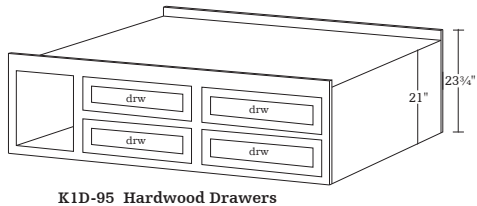

### 4 Drawer Platform

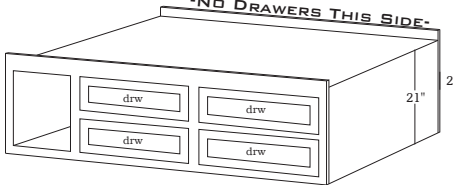

### 4 Drawer Platform

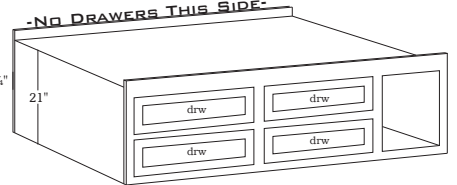

Available Bed Sizes  
Twin, Full, Queen, Eastern King & Western King

### 8 Drawer Platform

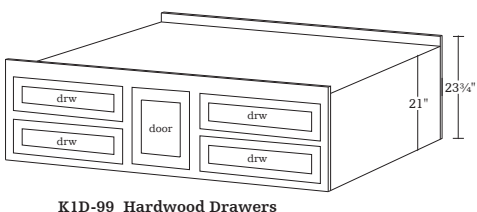

### 4 Drawer Platform

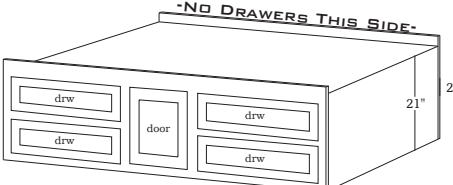

### 4 Drawer Platform

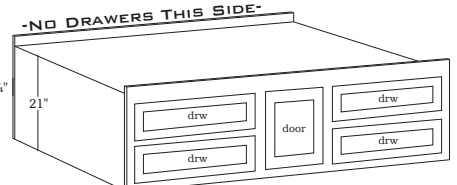

Available Bed Sizes  
Twin, Full, Queen, Eastern King & Western King

## Single High Valley View Headboards and Platform Footboards

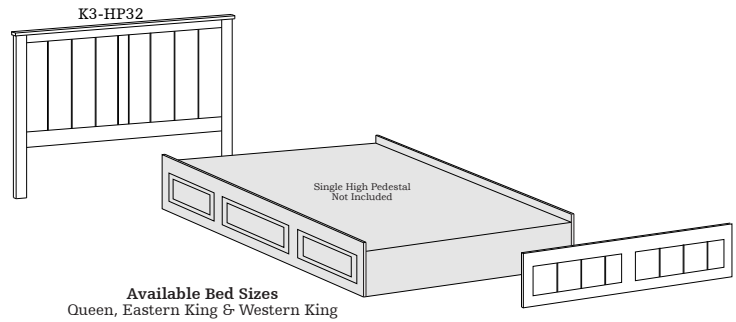
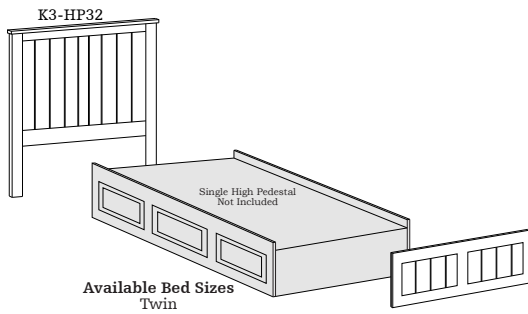

## Double High Valley View Headboards and Platform Footboards

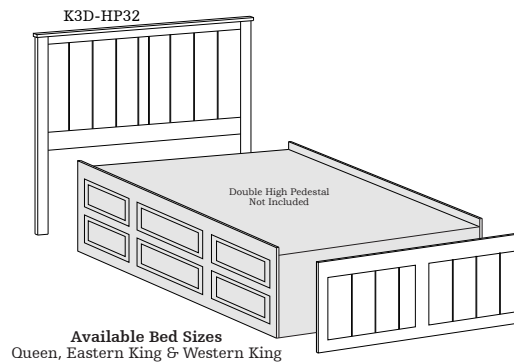
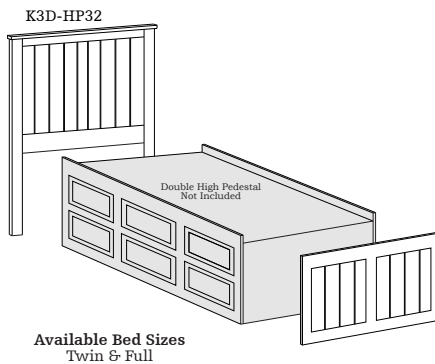

## Twin Bookcase Daybed

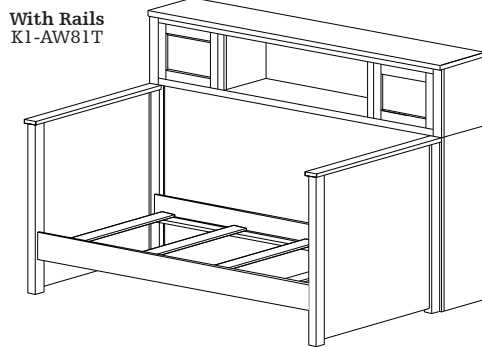

Without Rails  
Single High  
K1-AW82T  
  
Double High  
K1C-AW82T

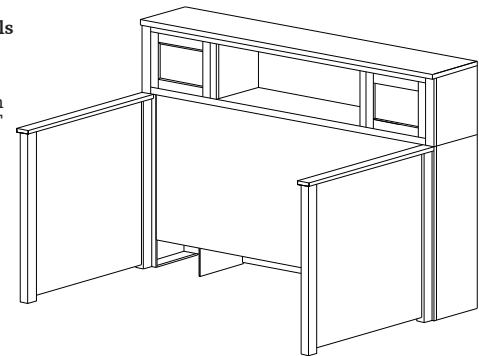

## Twin Bookcase Daybed

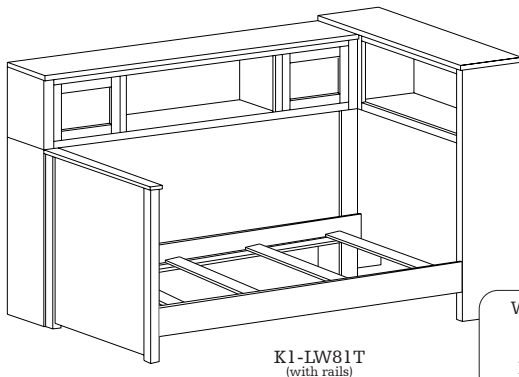

K1-LW81T  
(with rails)

Without Rails  
K1-LW82T  
(single high)  
K1C-LW82T  
(double high)

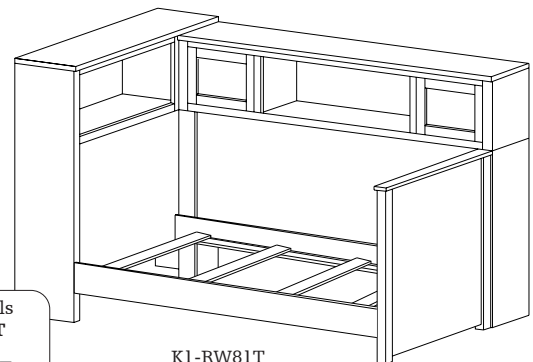

K1-RW81T  
(with rails)

Without Rails  
K1-RW82T  
(single high)  
K1C-RW82T  
(double high)

## Care Instructions

Those who select Stuart's Furniture enjoy years of beautiful use with minimal care. Maintain the beauty of the finish by protecting it from wear, spots, spills and by keeping it clean and dust free. Dust regularly, rubbing in the direction of the wood grain with a lint-free, absorbent cloth moistened by a few drops of furniture polish to keep this furniture looking its best. Avoid exposure to strong sunlight, which causes discoloration. Lift objects carefully; avoid dragging them over the wood surface. Avoid extreme heat and cold. Do not use polish remover, hair spray or perfume near the furniture, as this may damage the finish. Rubber or plastic products can sometimes cause a chemical reaction, which may deteriorate the finish. Do not use products containing silicone.