

Home Office Furniture



Stuart David

Home Furnishings

3419 Railroad Avenue Ceres, Ca 95307

Ph: 209.537.4751 Fax: 209.537.5349

www.stuartdavid.com

Stuart David

Home Furnishings

One size does not fit all. That's why Stuart David has created such an extensive Home Office Collection, designed with a variety of sizes and configurations, allowing you to pick the quality pieces that fit your needs the best. With our Home Office program you can create a: straight, wedge, partner, L or U shaped desk with options like: drawers, doors, file drawers, printer pullout shelf, or a space for your computer tower. You don't just get to choose the handmade pieces and configuration either; You also get to choose how they look with custom options like style, solid wood, finish, and hardware. Come visit our 25,000 square foot factory showroom to see the American made difference at Stuart David.



It is All About Choice

Choose How Your Office Will Look

1. Select a Style
2. Select a Wood
3. Select a Finish
4. Select Hardware

Steps for creating the perfect office...

Fine Hardwoods Available

- CHY** - Cherry
MAP - Maple
Oak - Red Oak
QS - Quartersawn (White Oak)
AK - Rustic Alder
CK - Rustic Cherry
HK - Rustic Hickory
OK - Rustic Oak

1. Select a Desk Layout

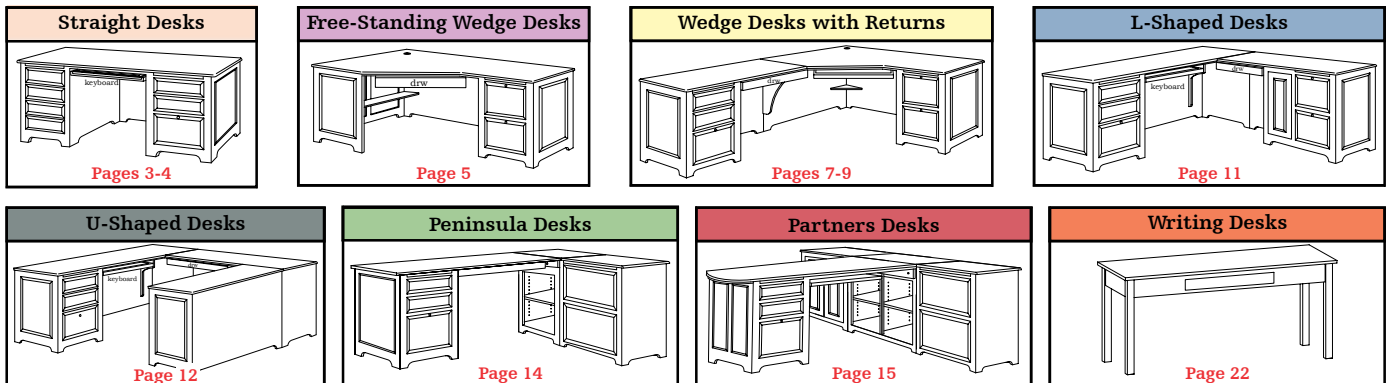

2. Select Base Units

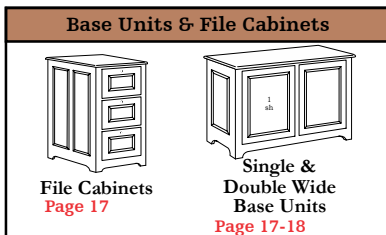

3. Select Uppers

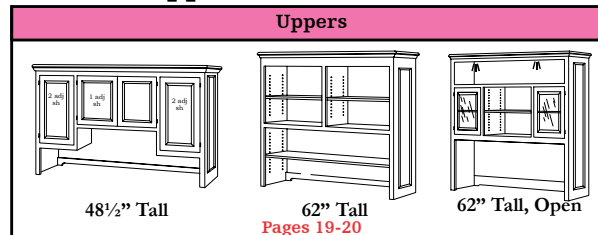

4. Matching Bookcases

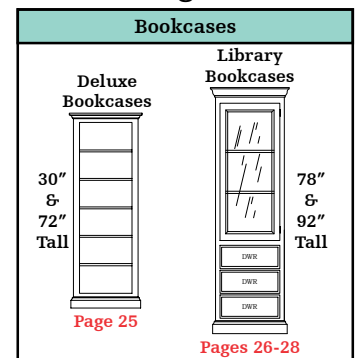

5. Select Options

| Options Key | | | | | |
|-------------|----------------------|--|---|--|---------------------------|
| | Size Modification \$ | | Left or Right Compartment \$ | | Paneled Back \$ |
| | Paneled Back \$ | | Pencil Drawer (In Place of Standard Keyboard Drawer) \$ | | Paneled End \$ |
| | Executive Back \$ | | Closed Keyboard Tray (In Place of Drawer) \$ | | Change 1 Door To Glass \$ |
| | Overhang Top \$ | | 1-14 LED Lights \$ | | Remove 1 Door \$ |
| | Bow Top \$ | | | | |

Additional Options, See Page 2 of Price List

R-Options

D-Options

*D2 Option Not Available In D6 Style

Select a Style

Classic 2 D2

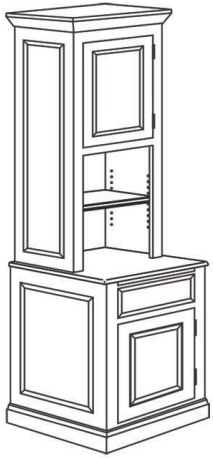

- Base Trim Approx 1" Overhang
- Raised Panels (Doors, Drawers, & Sides)

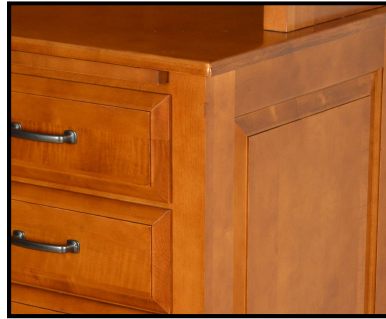

- Top Edge Profile For Desks & Base Units 1/4 Round
- Drawer Profile (Overlay)



- Top Trim Approx 2" Overhang
- Door Profile (Overlay)

For Open Base
Use D1 Style



Craftsman 5 D5

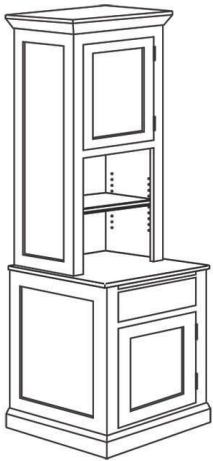

- Base Trim Approx 1" Overhang
- Recessed Panels (Doors, Drawers, & Sides)



- Top Edge Profile For Desks & Base Units Square
- Drawer Profile (Overlay)

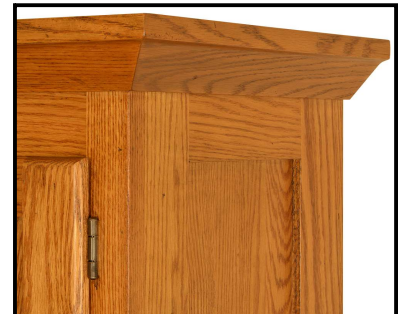

- Top Trim Approx 2" Overhang
- Door Profile (Overlay)

For Open Base
Use D4 Style



Sierra Vista D6

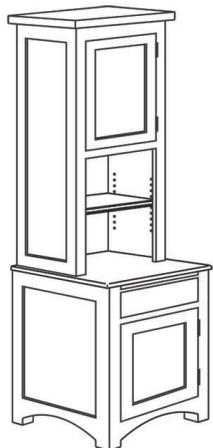

- Base Trim Arch Cut
- Recessed Panels (Doors, Drawers, & Sides)

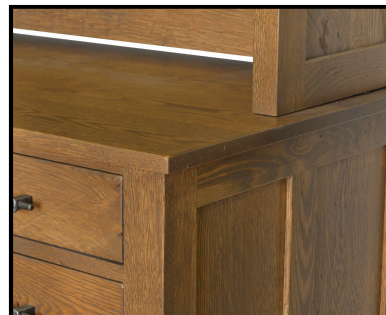

- Top Edge Profile For Desks & Base Units Eased Round
- Drawer Profile (Flush Fitting)



- Top Trim Approx 2" Overhang
- Door Profile (Flush Fitting)

Standard D6 Style is not available in units with 2 or more file drawers (listed below)

Premium Style
Plus 15%

•DN-F12 •DN-F13 •DN-F14 •DN-F23 •DN-F212 •DN-F222 •DN-10(2) •DN-11(2) •DN-242 •DN-342
•DN-024 •DN-24(F) •DN-025 •DN-TL724 •DN-TR724 •DN-TL733 •DN-TR733 •DN-BL71 •DN-BR71

*D2 Option Not Available
In D6 Style

Items above can be custom quoted for D6 style & will add approximately 2" to the height.

Select a Style

Oregon D7

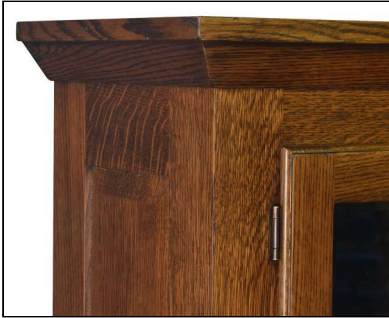

- Top Trim Approx 2" Overhang
- Door Profile (Overlay)



- Top Edge Profile For Desks & Base Units $\frac{1}{4}$ Round
- Drawer Profile (Overlay)



- Base Trim Wedge Cut
- Raised Panels (Doors, Drawers, & Sides)

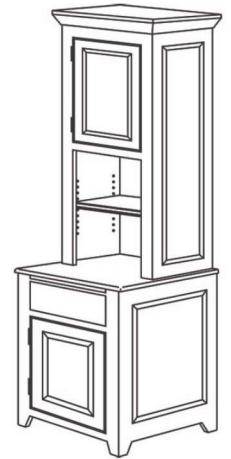

- Top Trim Approx 2½" Overhang
- Door Profile (Overlay)



- Top Edge Profile For Desks & Base Units $\frac{1}{4}$ Round
- Drawer Profile (Overlay)



- Base Trim Approx 1" Overhang
- Raised Panels (Doors, Drawers, & Sides)

Generations 9 D9

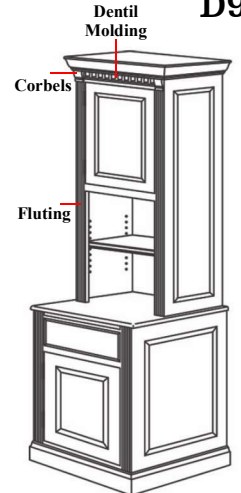

Corbels, Fluted & Dentil Moldings

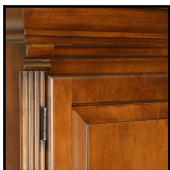

For No Dentil Molding
← Use D8 Style



- Top Trim Approx 2½" Overhang
- Door Profile (Overlay)

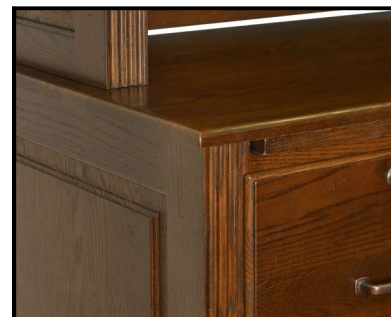

- Top Edge Profile For Desks & Base Units $\frac{1}{4}$ Round
- Drawer Profile (Overlay)



- Base Trim Approx 1" Overhang
- Specialty Raised Panels (Doors, Drawers, & Sides)

Madison 4 DM

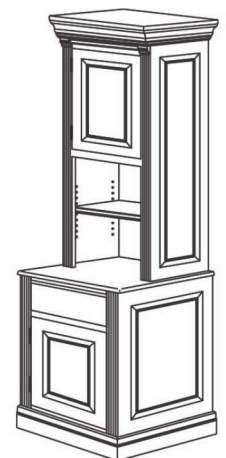

Corbels & Fluting



For No Fluting
No Corbels
← Use DN Style

Quality You Can Trust, Craftsmanship That Will Last!

Straight Desks

Width sizes listed are overall
(Including return trims & overhangs)

All items are available as shown or flush one or both sides.

Standard depth size is 22 $\frac{3}{4}$ "

Unless otherwise stated in **RED**

Standard file drawers fit 8 $\frac{1}{2}$ x 11

With rods running front to back



Options Key

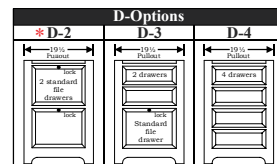
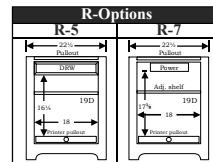
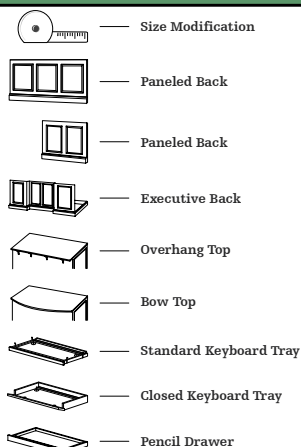

*D2 Option Not Available In D6 Style
Pages 3-5

34 $\frac{3}{4}$ " Wide Pg. 9

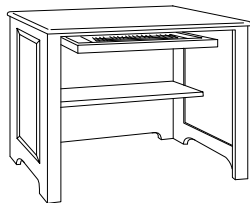

DN-D14K

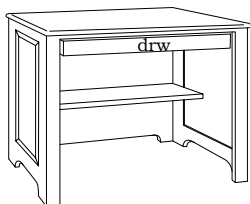

DN-D14D



44 $\frac{3}{4}$ " Wide Pg. 18

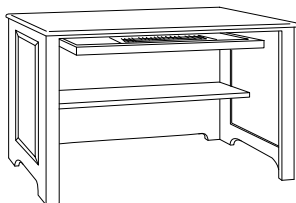

DN-D19K

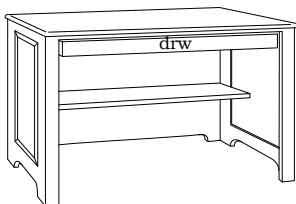

DN-D19D

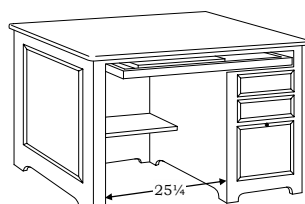

DN-DL19(R)

- ☐ Drawers on right (shown)
- ☐ Drawers on left (reversed)

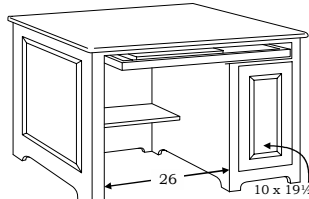

DN-DL19(D)

- ☐ Drawers on right (shown)
- ☐ Drawers on left (reversed)



52" Wide Pg. 21

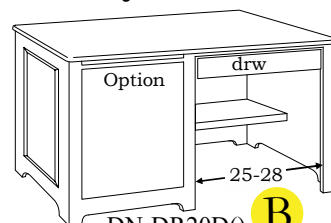

DN-DR20D() **B**

- ☐ Option on left (shown)
- ☐ Option on right (reversed)

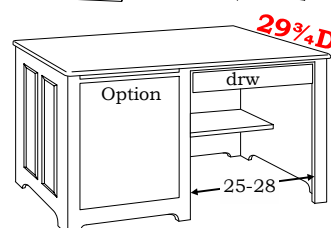
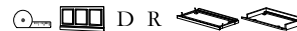

DN-DXR20D()

- ☐ Option on left (shown)
- ☐ Option on right (reversed)



American Made Solid Wood Furniture

Straight Desks

62 $\frac{1}{4}$ " Wide
Pg. 24-25

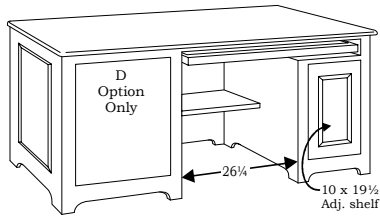

DN-DR22D()

- ☐ Option on left(shown)
- ☐ Option on right (reversed)

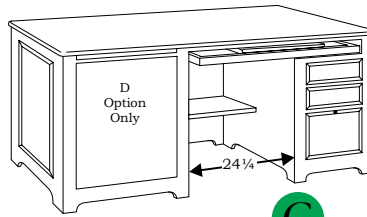

DN-DR22R()

- ☐ Option on left(shown)
- ☐ Option on right (reversed)

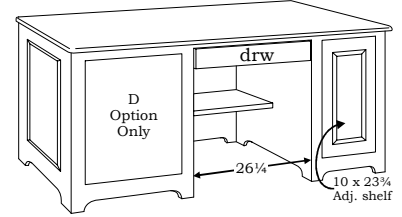

DN-DR122D()

- ☐ Option on left(shown)
- ☐ Option on right (reversed)

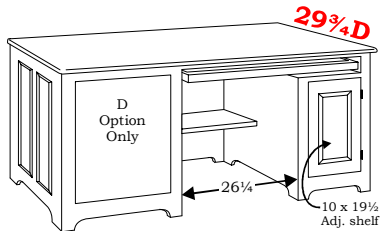
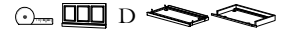

DN-DXR22D()

- ☐ Option on left(shown)
- ☐ Option on right (reversed)

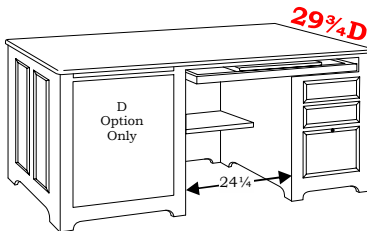

DN-DXR22R()

- ☐ Option on left(shown)
- ☐ Option on right (reversed)

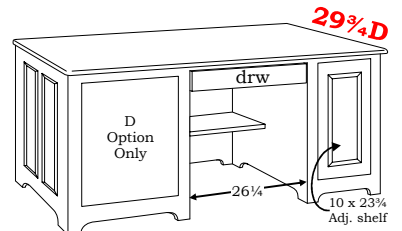

DN-DXR122D()

- ☐ Option on left(shown)
- ☐ Option on right (reversed)



66", 71" & 79 $\frac{1}{2}$ " Wide
Pg. 27, 28, 31, 32, 37, 38

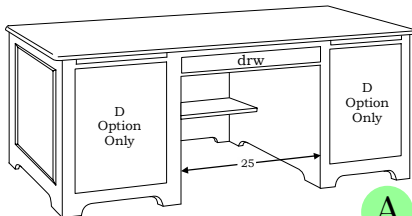

66" w - DN-D23D()

R-Options not Available at 66" Wide.

71" w - DN-D24D()

79 $\frac{1}{2}$ " w - DN-D25D()

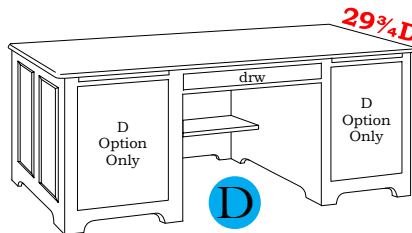

66" w - DN-DX23D()

R-Options not Available at 66" Wide.

71" w - DN-DX24D()

79 $\frac{1}{2}$ " w - DN-DX25D()



(Shown in D2 Style with #2 Option Left & #3 Right)



(Shown in D8 Style with #3 Option Left)



(Shown in D2 Style with #4 Option Left & #3 Right)



(Shown in D2 Style with #3 Option Left)

Wedge Desks



DN-GL24K()
(Shown in D1 Style with #3 Option)

66" Wide
Pg. 29

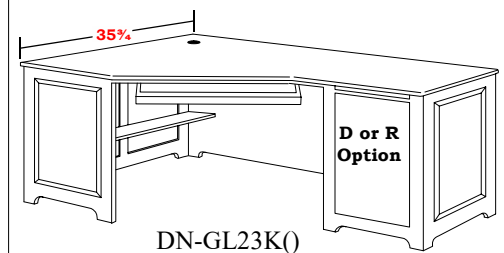

DN-GL23K()

- ☐ Option on left(reversed)
- ☐ Option on right (shown)



UN-25A(GO)
DN-GL25()
(Shown in D8 Style with #3 Option Left & #7 Right)

79½" Wide
Pg. 39

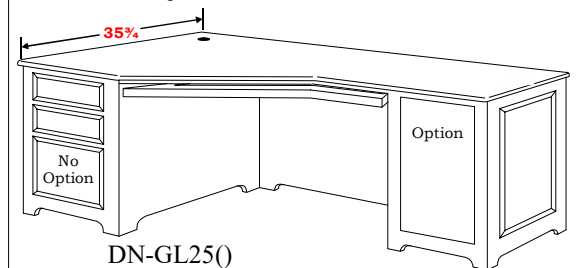

DN-GL25()

- ☐ Option on left(reversed)
- ☐ Option on right (shown)

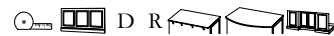

Wedge Desks with Returns



Quality You Can Trust, Craftsmanship That Will Last!

Wedge Desks with Returns

66" Wide

Pg. 42

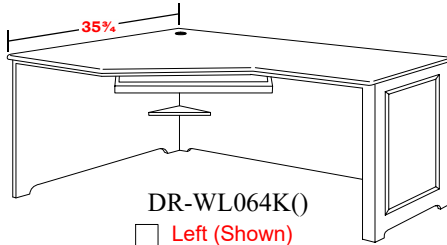

DR-WL064K()

- ☐ Left (Shown)
- ☐ Right (Reversed)

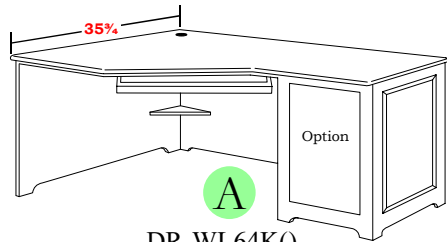

DR-WL64K()

- ☐ Option on Left (Shown)
- ☐ Option on Right (Reversed)



Standard depth size is **22³/₄"** unless otherwise stated in **Red**

Standard file drawers fit **8¹/₂ x 11** with rods running front to back

| Options Key | | | |
|-------------|---------------------------|--|-------------------|
| | Size Modification | | 1-14 LED Lights |
| | LED Light Standard | | Pencil Drawer |
| | Paneled Back | | Wood Door Option |
| | Paneled End | | Glass Door Option |
| | Overhang Top | | Remove 1 Door |
| | Bow Top | | |
| | Left or Right Compartment | | |

R-Options

D-Options

*D2 Option Not Available In D6 Style

Pages 7-9



(Shown in D2 Style with #2 Option Left & #3 Option Right)

79¹/₂" Wide

Pg. 43

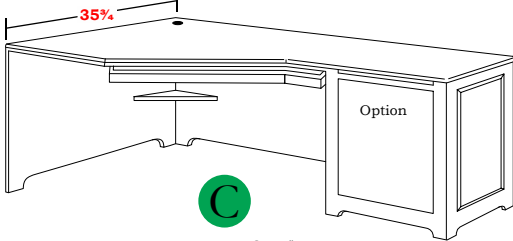

DR-WL78K()

- ☐ Option on Left (Reversed)
- ☐ Option on Right (Shown)



(Shown in D2 Style with #5 Option Left & #3 Option Right)

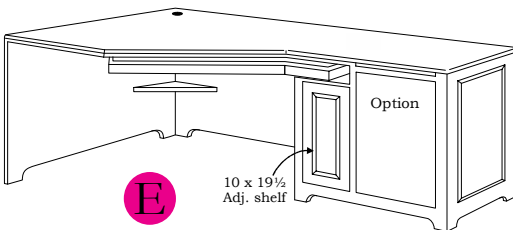

DR-WL278K()

- ☐ Option on Left (Reversed)
- ☐ Option on Right (Shown)



(Shown in D8 Style with #5 Option Left)

American Made Solid Wood Furniture

Returns for Wedge Desks

Return Orientations

Returns are Available Reversed as Shown

Left

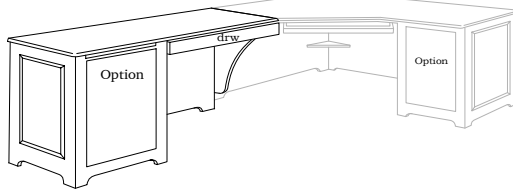

Right

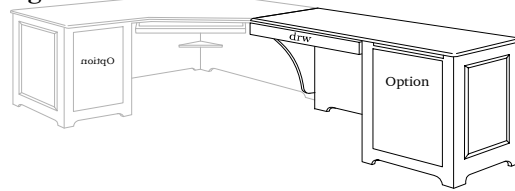

30 $\frac{1}{4}$ " Wide

Pg. 44-45

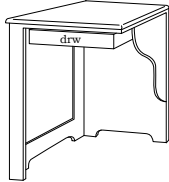

DN-TL711

- ☐ Left (Shown)
☐ Right (Reversed)

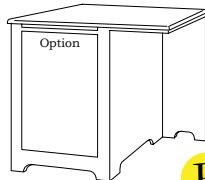

DN-TL712()

- ☐ Option on left(shown)
☐ Option on right (reversed)



DN-TL712()

(Shown in D2 Style with #2 Option)

35 $\frac{1}{4}$ " Wide

Pg. 44-45

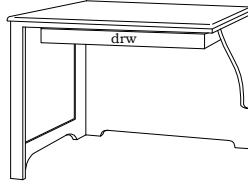

DN-TL721

- ☐ Left (Shown)
☐ Right (Reversed)

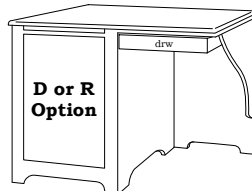

DN-TL722()

- ☐ Option on left(shown)
☐ Option on right (reversed)

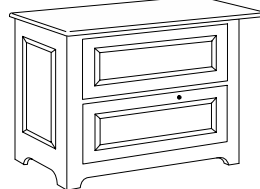

DN-TL724

- ☐ Option on left(shown)
☐ Option on right (reversed)

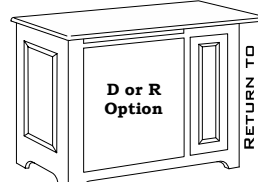

DN-TL723()

- ☐ Option on left (Shown)
☐ Option on right (Reversed)

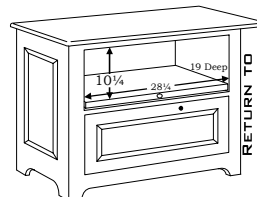

DN-TL725

- ☐ Drawers on left(shown)
☐ Drawers on right (reversed)



51 $\frac{1}{2}$ " Wide

Pg. 44-45

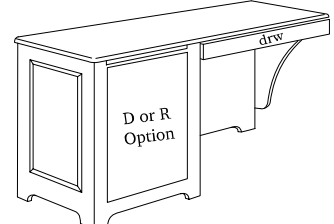

DN-TL731()

- ☐ Option on left (Shown)
☐ Option on right (Reversed)

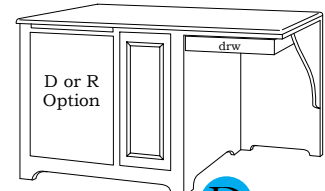

DN-TL732()

- ☐ Option on left (Shown)
☐ Option on right (Reversed)

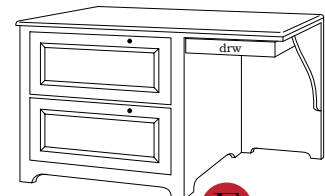

DN-TL733()

- ☐ Drawers on left(shown)
☐ Drawers on right (reversed)

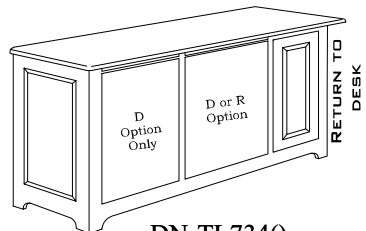

DN-TL734()

- ☐ Doors on left(shown)
☐ Doors on right (reversed)



DN-TL731()

(Shown in D9 Style with #3 Option)



DN-TL733()

(Shown in D9 Style)

Quality You Can Trust, Craftsmanship That Will Last!

Layouts for Desks with Returns

For Desks with 30 $\frac{1}{4}$ " - 35 $\frac{1}{4}$ " Wide Returns

Pg. 46-48

48 $\frac{1}{2}$ " & 62" Tall

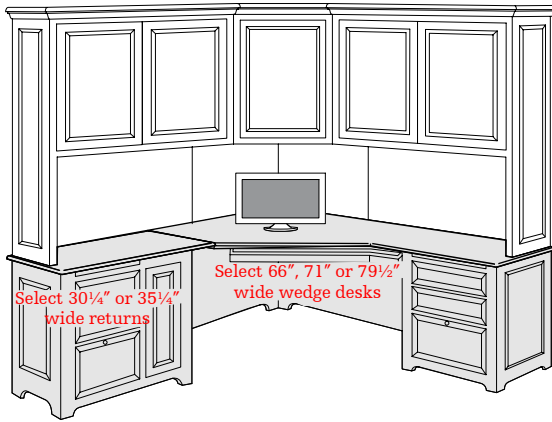

62" Tall Only

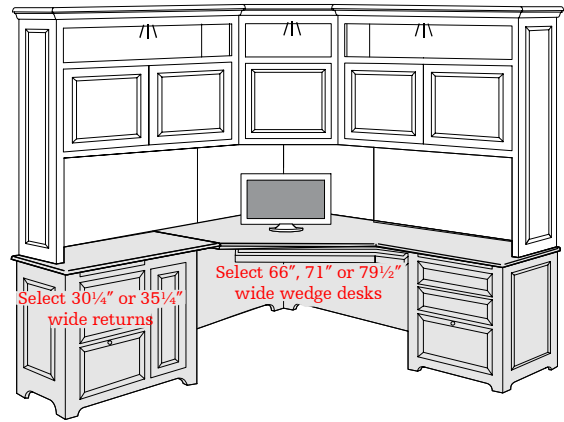

For Desks with 50 $\frac{1}{2}$ " Wide Returns

Pg. 46-48

48 $\frac{1}{2}$ " & 62" Tall

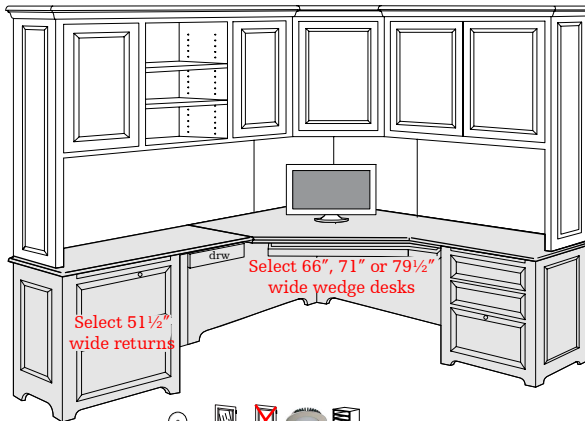

62" Tall Only

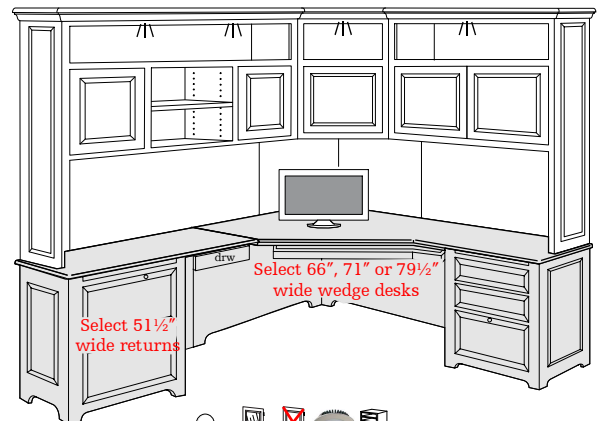

For Desk Returns up to 97" Wide

Pg. 49

48 $\frac{1}{2}$ " & 62" Tall Only

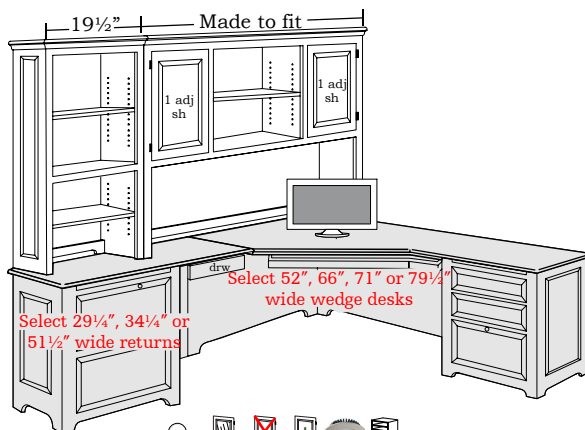

62" Tall Only

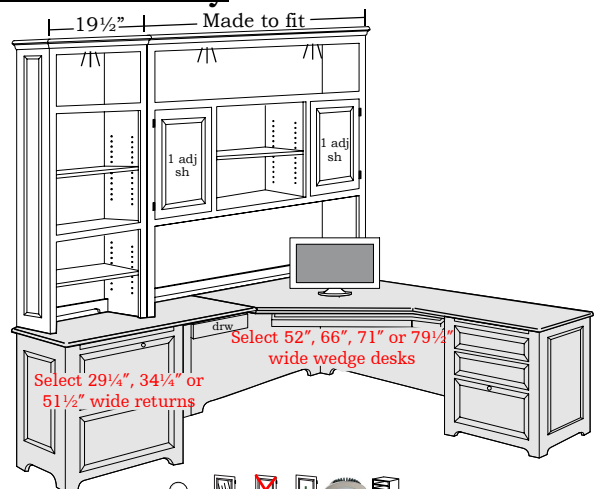

American Made Solid Wood Furniture

L Shaped Desks & Returns



Quality You Can Trust, Craftsmanship That Will Last!

L Shaped Desks & Returns

Standard depth size is **22³/₄"**
 Unless otherwise stated in **Red**
 Standard file drawers fit **8¹/₂ x 11**
 With rods running front to back

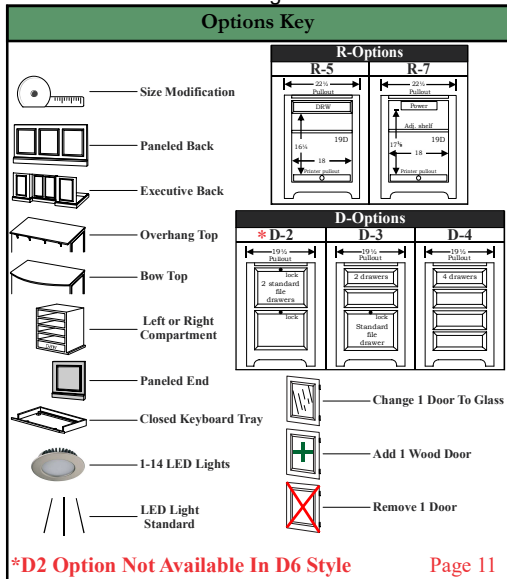

48" & 62" Tall Upper

Pg. 49

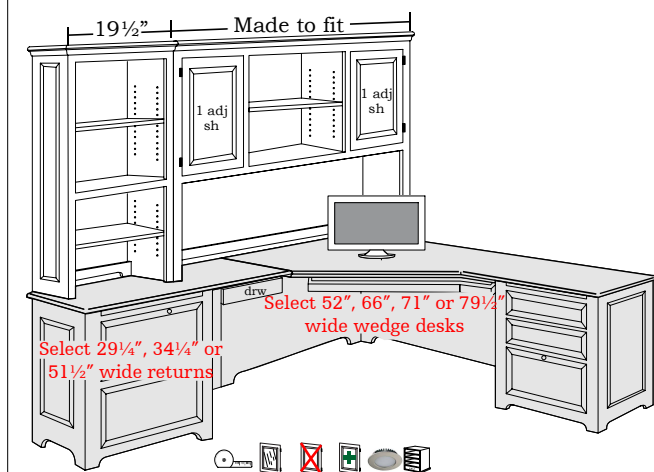

62" Tall Upper Only

Pg. 49

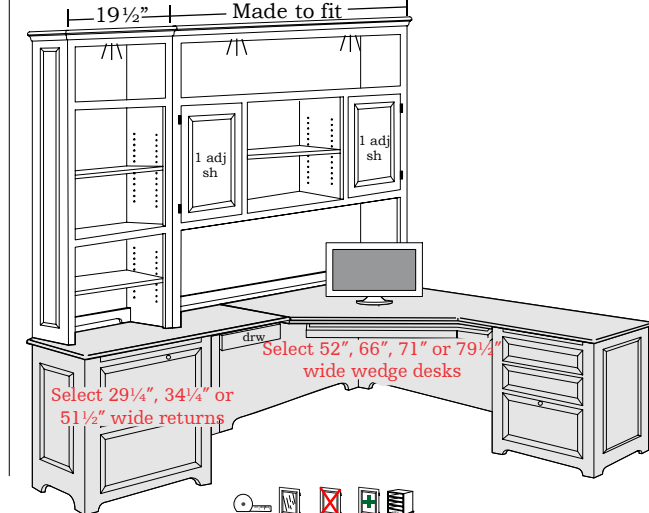

48¹/₄" Wide Returns 71 & 79¹/₂" Wide Desks

Pg. 52

Pg. 50-51

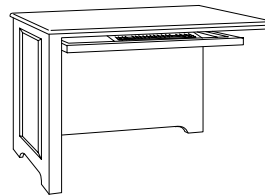

- ☐ Left (Shown)
- ☐ Right (Reversed)

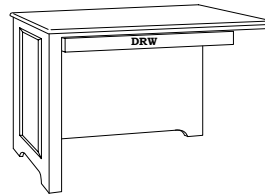

- ☐ Left (Shown)
- ☐ Right (Reversed)

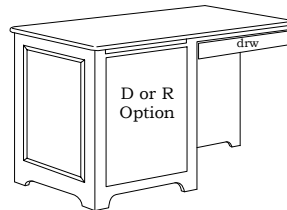

- ☐ Option on left(shown)
- ☐ Option on right (reversed)

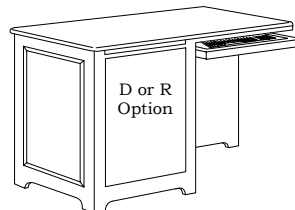

- ☐ Option on left(shown)
- ☐ Option on right (reversed)

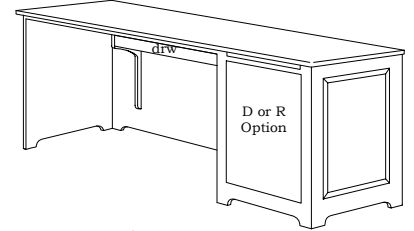

- ☐ Keyboard on left (reversed)
- ☐ Keyboard on right (shown)

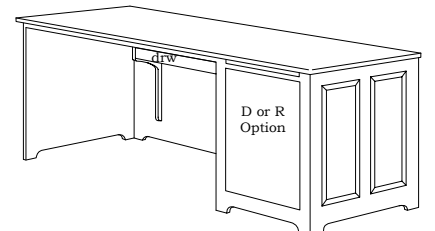

- ☐ Drawer on left(shown)
- ☐ Drawer on right (reversed)



58³/₄" Wide Returns

Pg. 52

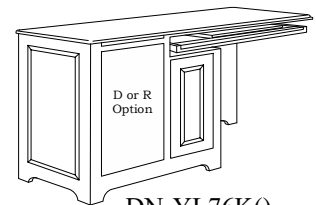

- ☐ Option on left(shown)
- ☐ Option on right (reversed)

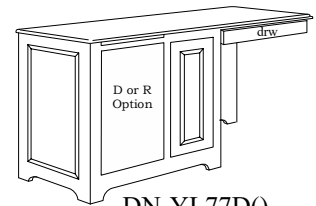

- ☐ Option on left(shown)
- ☐ Option on right (reversed)



U-Shaped Desks



| Options Key | | | |
|---|--------------------------------|-----------|--|
| | Size Modification | | |
| | Paneled Back | | |
| | Closed Keyboard Tray | | |
| D-Options | | | |
| D-2 | D-3 | D-4 | |
| | | | |
| 2 standard drawers | 2 drawers 1 Standard drawer | 4 drawers | |
| *D2 Option Not Available In D6 Style Page 12 | | | |

64³/₄" & 70³/₄" Wide
Pg. 13

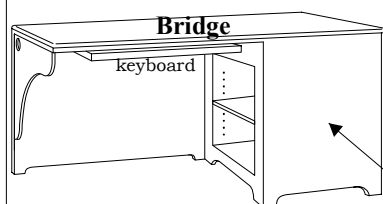

- ☐ Drawer on left(shown)
- ☐ Drawer on right (reversed)

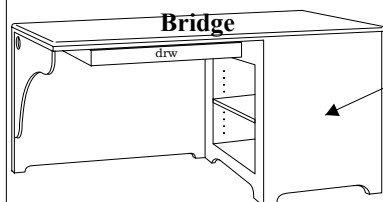

- ☐ Drawer on left(shown)
- ☐ Drawer on right (reversed)



Note:
Any **23³/₄"** Deep
Base Unit Can Be
Used With Bridge

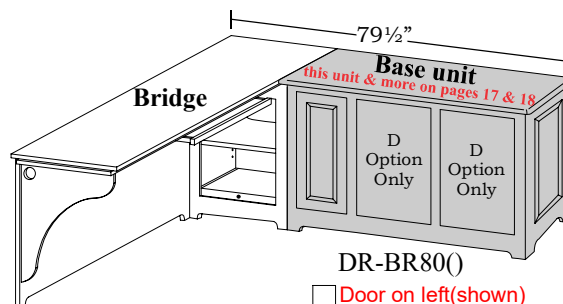

DR-BR80()

- ☐ Door on left(shown)
- ☐ Door on right (reversed)

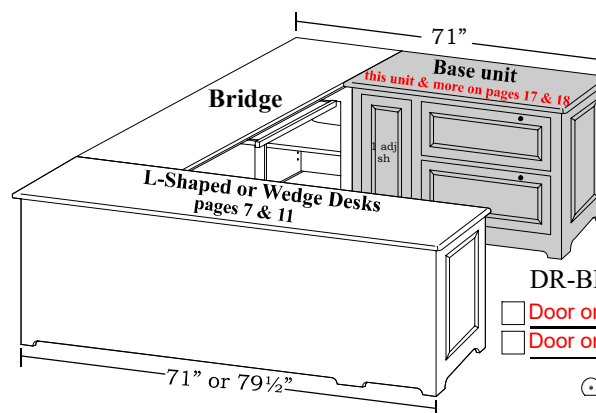

DR-BR71

- ☐ Door on left(shown)
- ☐ Door on right (reversed)



Peninsula and Partners Desks



American Made Solid Wood Furniture

Peninsula Desks

59½" Wide Desk

Available reversed Pg. 6

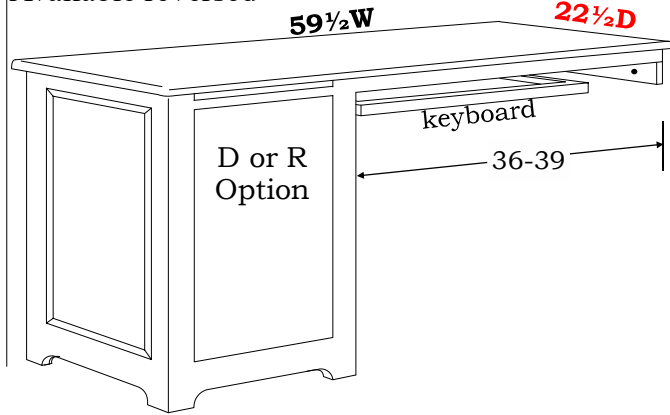

- DN-ML160K
- ☐ Option on left (shown)
 - ☐ Option on right (reversed)
 - ☐ D R ☐ ☐ ☐

24½" Wide Desk Mate

Pg. 6

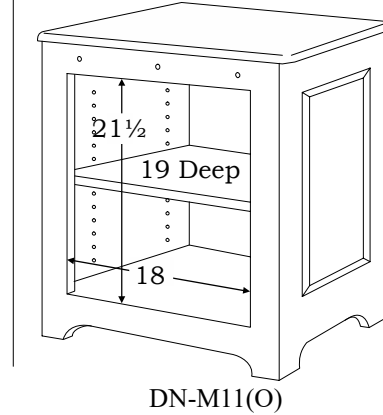

Standard depth size is 22¾"
Unless otherwise stated in **Red**
Standard file drawers fit 8½ x 11
With rods running front to back

Options Key

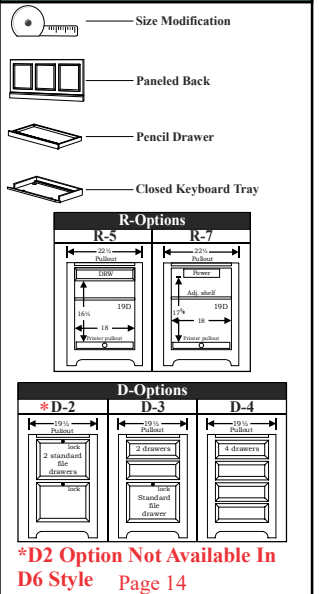

59½" Wide Desk

Available reversed Pg. 10

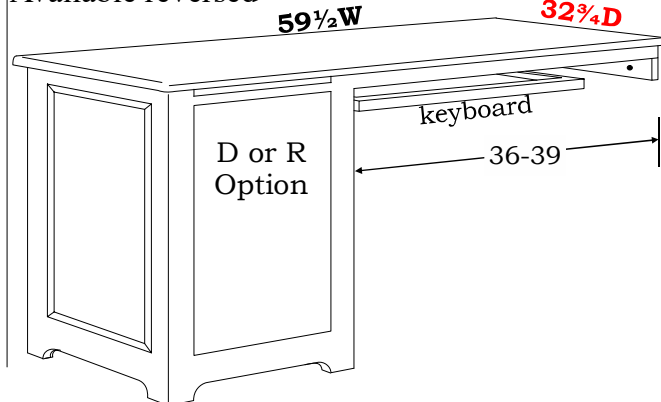

- DN-ML260K
- ☐ Option on left (shown)
 - ☐ Option on right (reversed)
 - ☐ D R ☐ ☐ ☐

34¾" Wide Desk Mate

Pg. 10

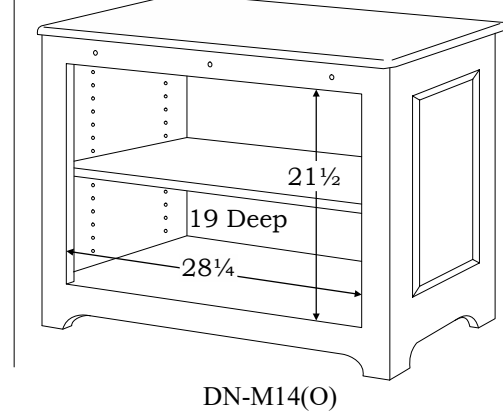

Partners Desks

58" Wide Desk

Pg. 13

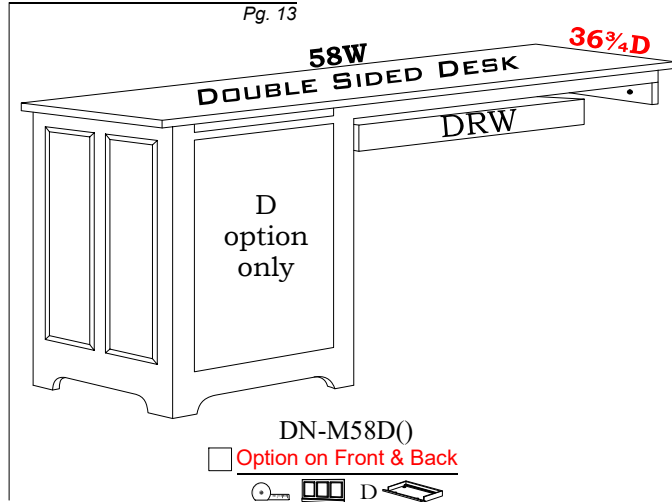

DN-M58D()

☐ Option on Front & Back



38 3/4" Wide Desk Mate

Pg. 13

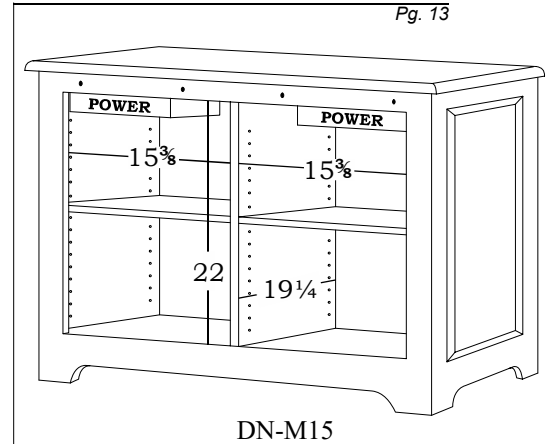

DN-M15

Standard depth size is **22 3/4"**

Unless otherwise stated in **Red**

Standard file drawers fit **8 1/2 x 11**

With rods running front to back

Options Key

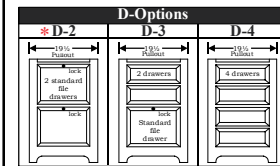
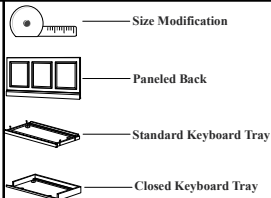

***D2 Option Not Available In D6 Style Page 15**

65" Wide Desk

Pg. 13

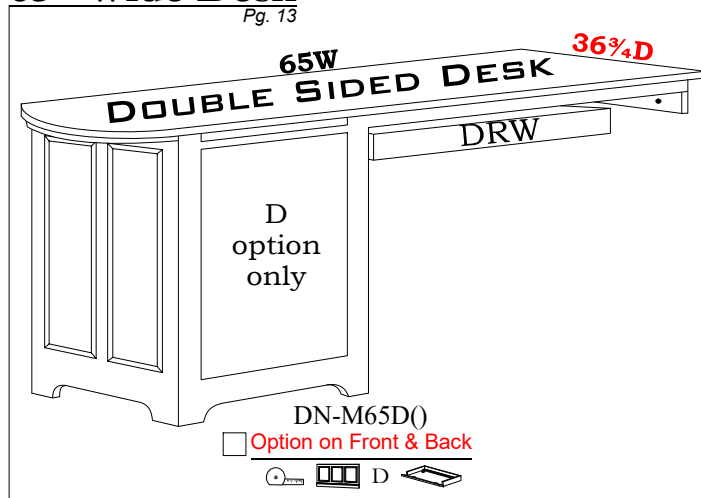

DN-M65D()

☐ Option on Front & Back



American Made Solid Wood Furniture

Base Units, File Cabinets & Computer Stations



A

(Shown in D2 Style)



B

(Shown in D4 Style)



C

DN-342

(Shown in D2 Style)



D

DN-24(F)

(Shown in D4 Style)

Quality You Can Trust, Craftsmanship That Will Last

Base Units & File Cabinets

21½" Wide Pg. 3

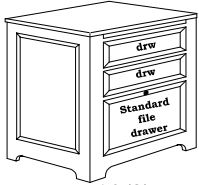

DN-10(3)

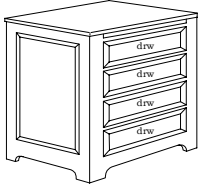

DN-10(4)



21½" & 24½" Wide Pg. 3 & 5



21½"w - DN-10(O)
24½"w - DN-11(O)

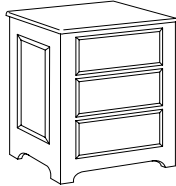

21½"w - DN-10(R)
24½"w - DN-11(R)

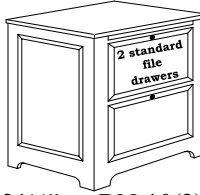

21½"w - DN-10(2)
24½"w - DN-11(2)



For DN-11(2) Only
Accepts 8½ x 11 or 8½ x 14

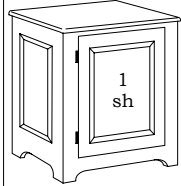

21½"w - DN-10(D)
24½"w - DN-11(D)

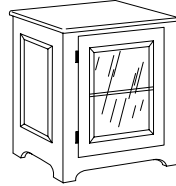

21½"w - DN-10(G)
24½"w - DN-11(G)



24½" Wide Pg. 5

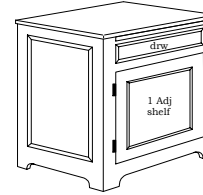

DN-11(5)

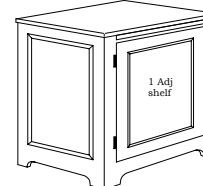
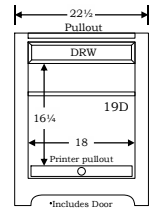

DN-11(7)

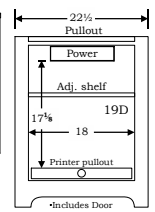

34¾" Wide Pg. 9

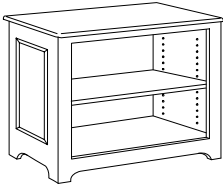

DN-14(O)

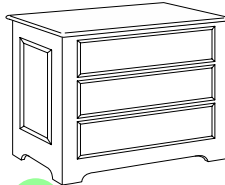

A DN-14(R)

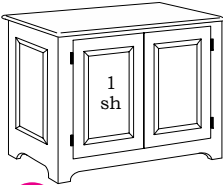

E DN-14(D)

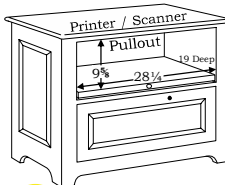

B DN-232

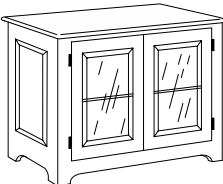

DN-14(G)

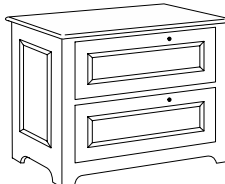

DN-242



40¾" Wide Pg. 15

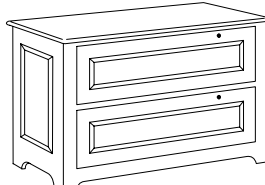

C DN-342



For DN-342 Only
Accepts 8½ x 11 or 8½ x 14

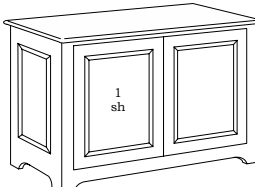

DN-26(D)

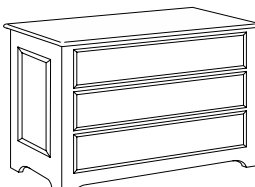

DN-26(R)



E

(Shown in DM Style)

Standard depth size is **22¾"**
Unless otherwise stated in **Red**

Standard file drawers fit **8½ x 11**
With rods running front to back

Options Key



Size Modification



Paneled Back



Paneled Back



Paneled Back

| D-Options | | | R-Options | |
|-----------|-----|-----|-----------|-----|
| *D-2 | D-3 | D-4 | R-5 | R-7 |
| | | | | |

*D2 Option Not Available In D6
Style

Pages 17-19

Base Units, File Cabinets & Computer Stations

40³/₄" Wide

Computer Stations

With Keyboard & Printer Pullouts Pg. 15

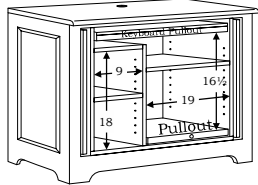

F DN-952

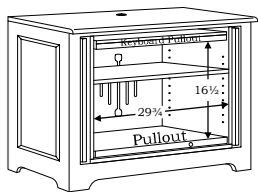

DN-953

44³/₄" Wide

Pg. 18

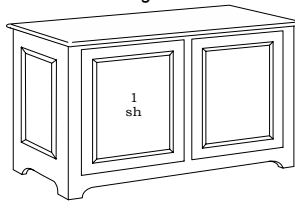

DN-19(D)

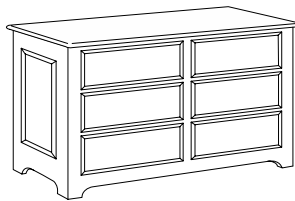

DN-19(R)

71" Wide

Pg. 33

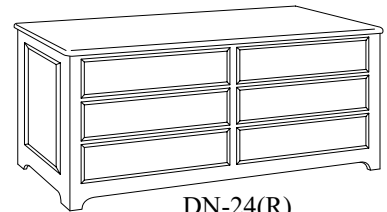

DN-24(R)



D DN-24(F)

71" Wide

Pg. 33

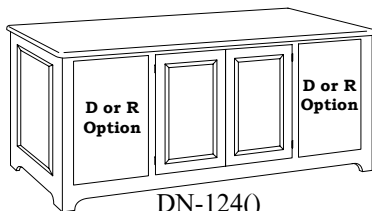

DN-124()
D R



G DN-924(DO)

71" & 79¹/₂" Wide

Pg. 33 & 38

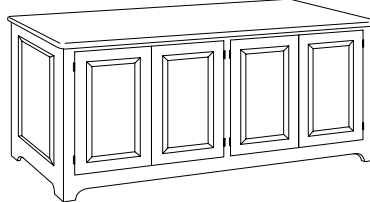

DN-25(D)
DN-24(D)

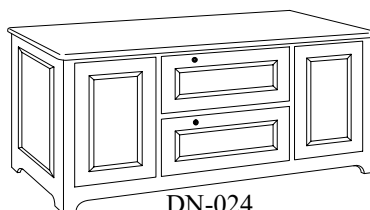

DN-024
DN-025



F
(Shown in D1 Style)

The Home Office Program Can Be Used In
Conjunction With The Home Entertainment Program

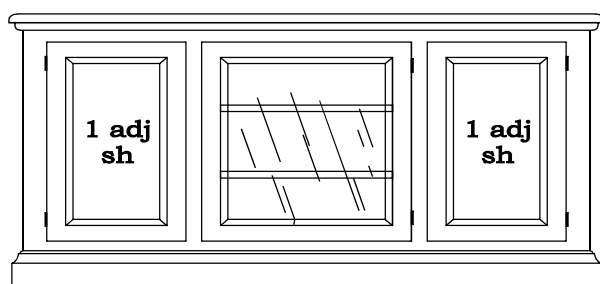

G
(Shown in D8 Style)

Quality You Can Trust, Craftsmanship That Will Last!

Uppers For Desks & Base Units

21½" - 24½" Wide

Pg. 4, 7 & 8

48½" & 62" Tall

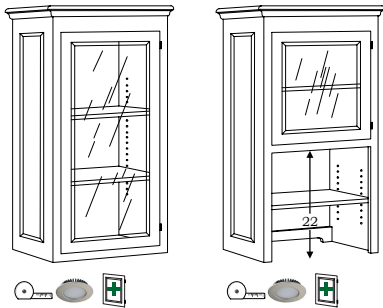
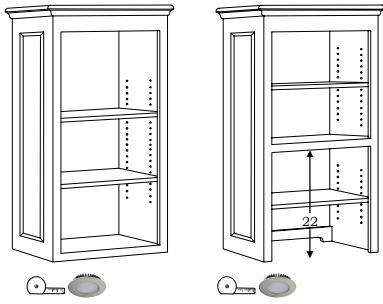

62" Tall Only

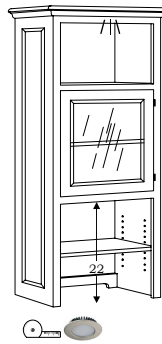
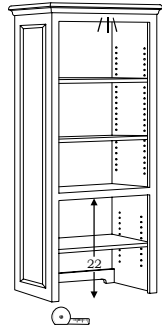

34¾" - 40¾" Wide

Pg. 11, 12, 14, 16, & 17

48½" & 62" Tall

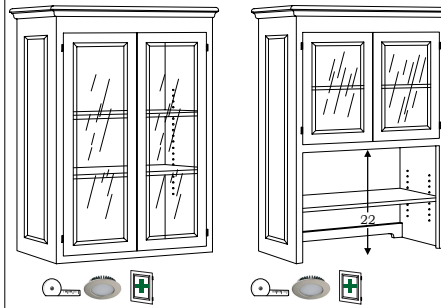
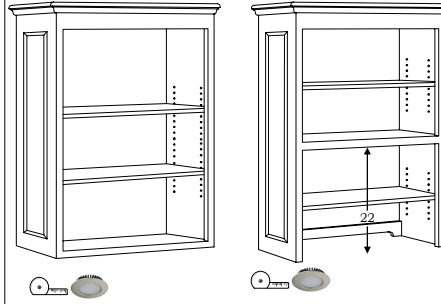

62" Tall Only

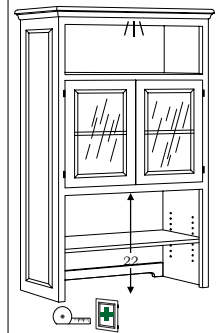
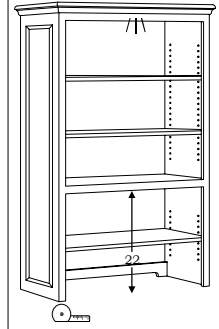

44¾" - 52" Wide

Pg. 19, 20 & 23

48½" & 62" Tall

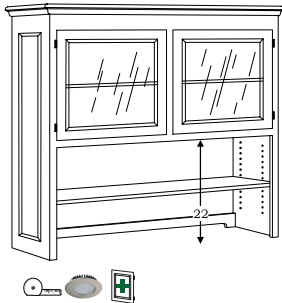
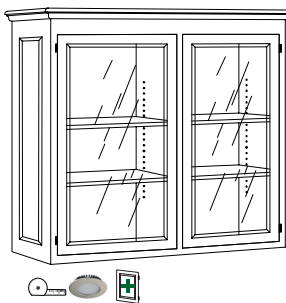
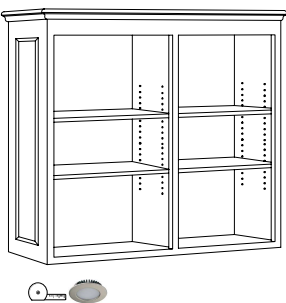

62" Tall Only

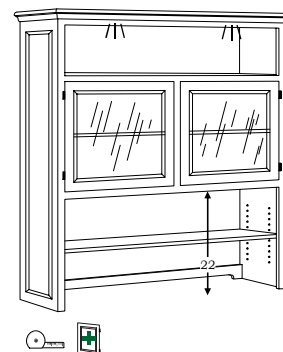
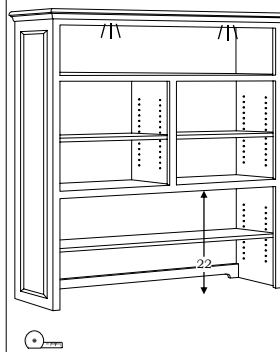

Options Key

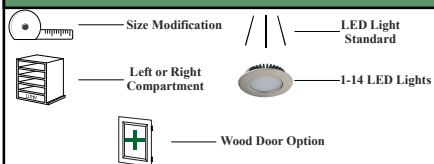

Pages 21-22

American Made Solid Wood Furniture

Uppers For Desks & Base Units

52" Wide

Pg. 22

48½" Tall Only

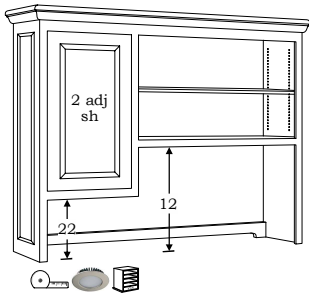

- ☐ Door on Left (Shown)
- ☐ Door on Right (Reversed)

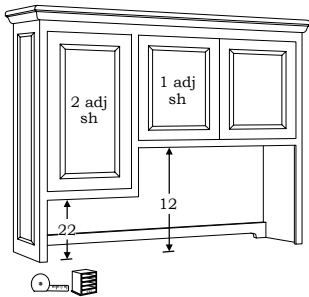

- ☐ Large Door on Left (Shown)
- ☐ Large Door on Right (Reversed)

33¼" Tall Only

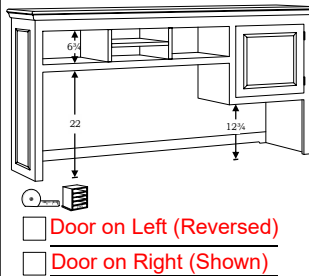

- ☐ Door on Left (Reversed)
- ☐ Door on Right (Shown)

62¼" Wide

Pg. 26

48½" Tall Only

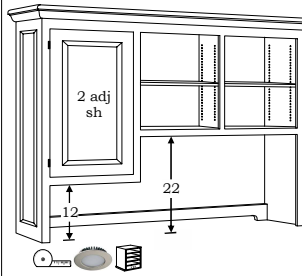

- ☐ Door on Left (Shown)
- ☐ Door on Right (Reversed)

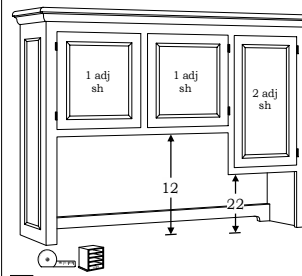

- ☐ Large Door on Left (Shown)
- ☐ Large Door on Right (Reversed)

62¼" Wide

To

79½" Wide

Pg. 26, 30, 34, 40

48½" & 62" Tall

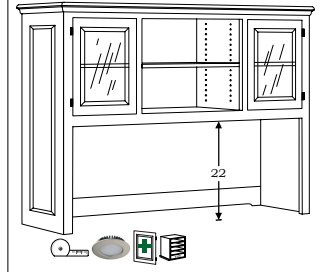

62" Tall Only

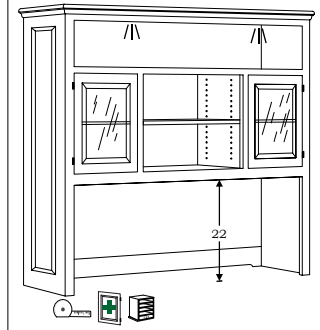

71" Wide

Pg. 36

48½" & 62" Tall

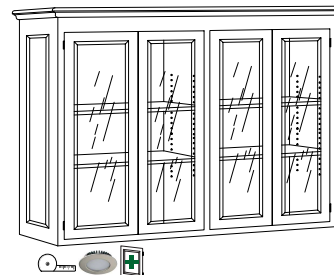
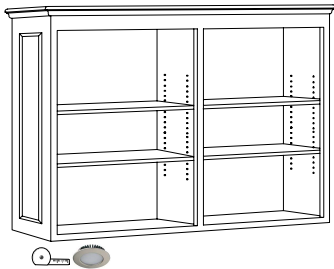

71" Wide & 79½" Wide

Pg. 35 & 41

48½" & 62" Tall

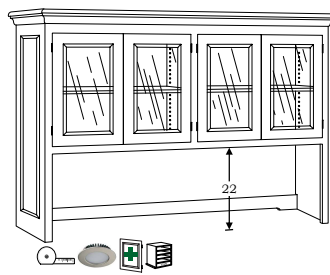
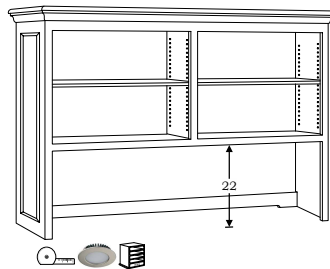

66" Wide & 71" Wide

Pg. 30 & 34

48½" Tall

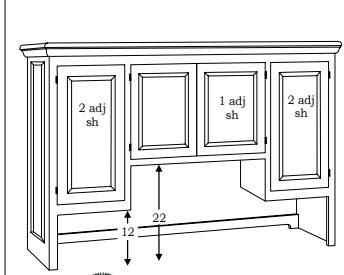
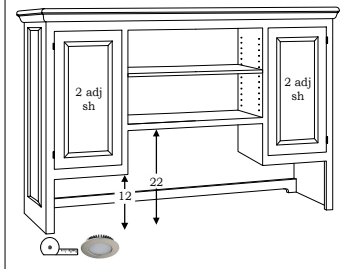

File Cabinets

For additional file cabinets see pages 17 & 18

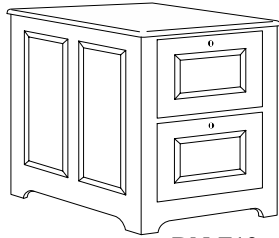

DN-F12
24"W x 25½"D x 29½"H

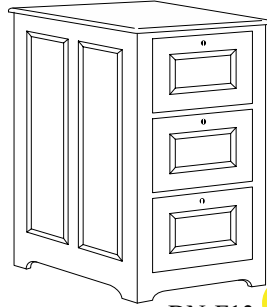

DN-F13 **B**
24"W x 25½"D x 41¾"H

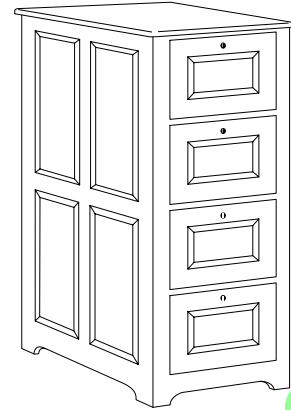

DN-F14 **A**
24"W x 25½"D x 54"H

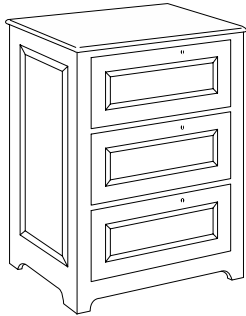

DN-F23
34¾"W x 22¾"D x 41¾"H

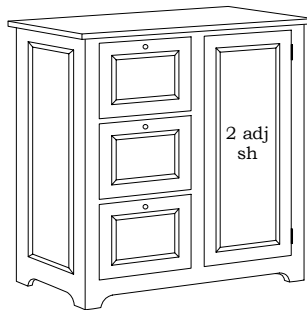

DN-F212
38¾"W x 22¾"D x 41¾"H

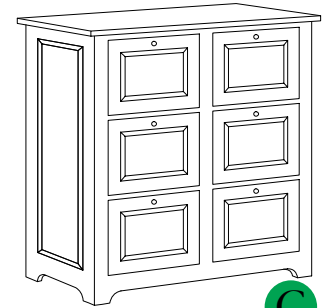

DN-F222 **C**
38¾"W x 22¾"D x 41¾"H



A
(Shown in D2 Style)



B
(Shown in D5 Style)



C
(Shown in D2 Style)

American Made Solid Wood Furniture

Writing Desks

Straight Desks

All Desks 30" tall



D4-EC20(F)
18w x 23d x 24h

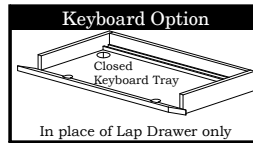

D4-E36(D)



D4-E48(D)



D4-E66(D)



D4-EX66(D)
*No Wedge Option

Left Layout

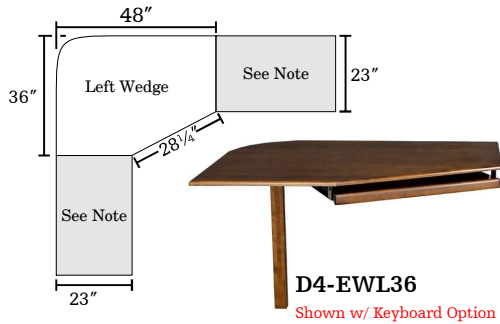

D4-EWL36
Shown w/ Keyboard Option

Wedge Desks

All Desks 30" tall

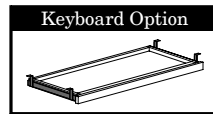

Note:
Attach any desk shown above
or
Attach any 23" deep unit
from the home office catalog

Right Layout

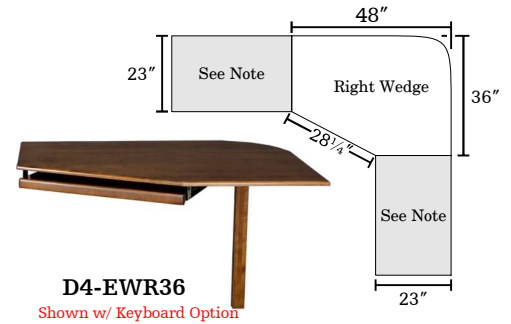

D4-EWR36
Shown w/ Keyboard Option

L-Shaped Desks

Left Desks & Returns

All Desks & Returns 30" tall

Right Desks & Returns



D4-GPL59(D)
66 x 59w 23d 30h
D4-GPL66(D)
66 x 66w 23d 30h

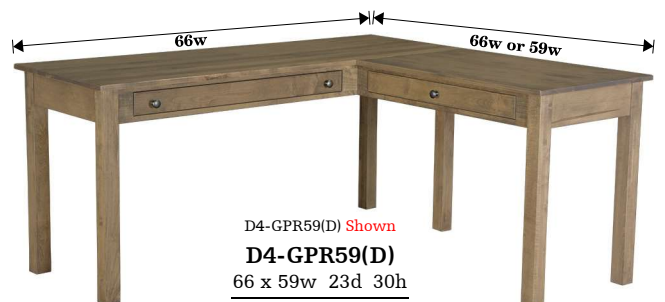

D4-GPR59(D)
66 x 59w 23d 30h
D4-GPR66(D)
66 x 66w 23d 30h

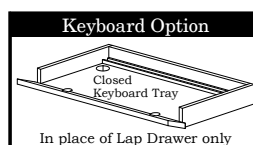

D-CKB

Stuart David Home Furnishings

Deluxe Bookcases

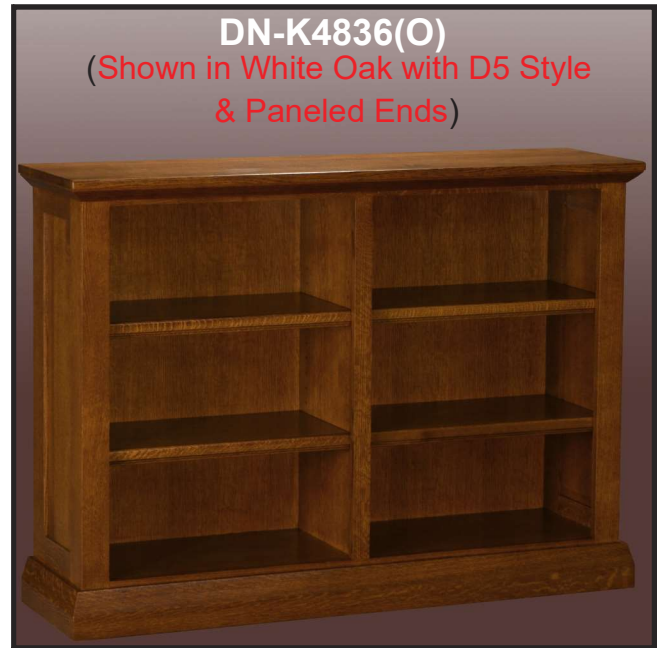

It's all about choice: 1 Type of wood 2 Finish 3 Size 4 Hardware

Fine Hardwoods Available

CHY - Cherry
MAP - Maple
Oak - Red Oak
QS - Quartersawn
 (White Oak)
AK - Rustic Alder
CK - Rustic Cherry
HK - Rustic Hickory
OK - Rustic Oak

Styles Available

D2 - Classic 2 (Use **D1** For Open Base)
D5 - Craftsman 5 (Use **D4** For Open Base)
D9 - Generations 9 (Use **D8** For
 No Dentil Molding)
DM - Madison 4 (Use **DN** For No Flutting)

Deluxe Bookcases

See Bookcase Section For Information

Options Key

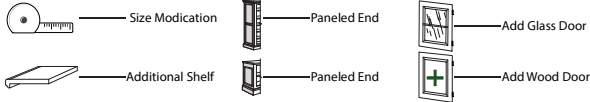

Page 24

2" Wide

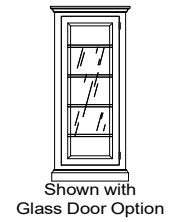
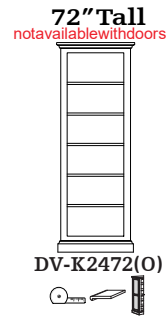
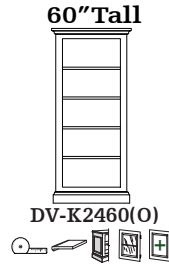
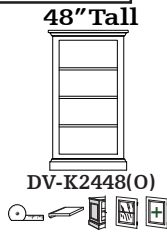

Case Width 24"

33", 39", 45" Wide

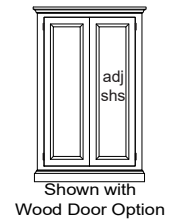
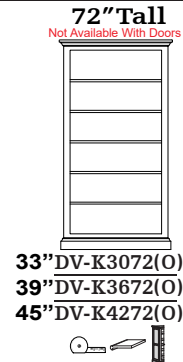
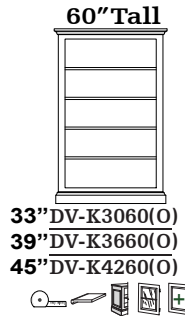
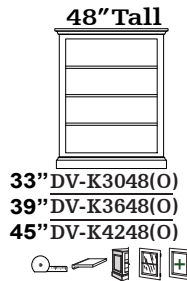
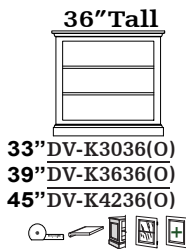
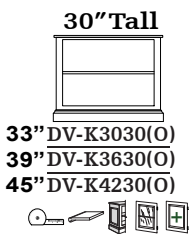

*Case Width 30, 36, 42"

50" Wide

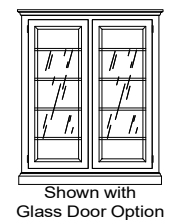
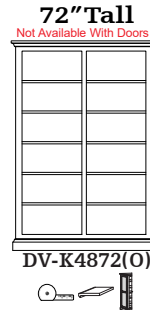
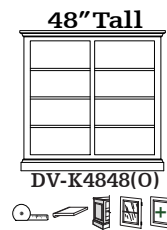
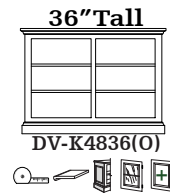
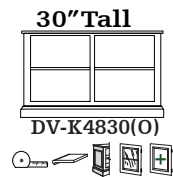

*Case Width 47 1/4"

62" Wide

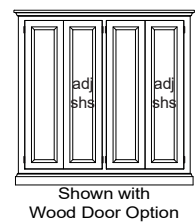
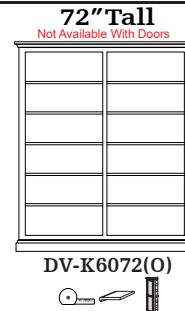
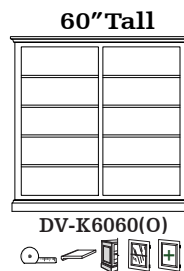
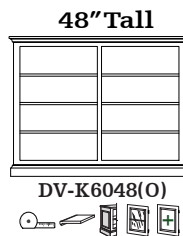
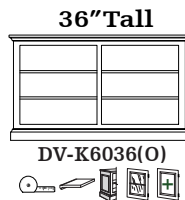
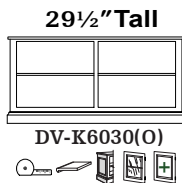

*Case Width 59 1/4"

74" Wide

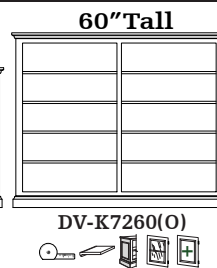
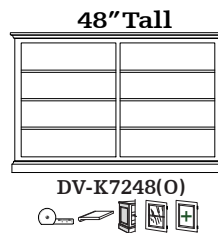
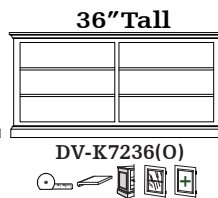
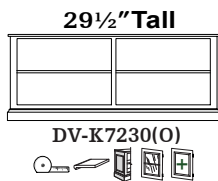

72" Tall Not Available

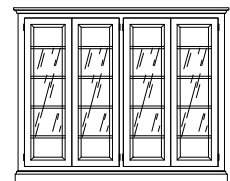

*Case Width 71 1/4"

| ITEM # | | | | ITEM # | | | | ITEM # | | | | ITEM # | | | |
|--------|--------|-------|-----|--------|--------------|---------------|----------------|------------|-------|--|-------|----------|------|--------|--|
| WOOD | Cherry | Maple | Oak | QS Oak | Rustic Alder | Rustic Cherry | Rustic Hickory | Rustic Oak | Style | | Color | Hardware | Door | Extras | |
| | | | | | | | | | | | | | QTY: | | |