

Home Office Furniture



Stuart David

Home Furnishings

3419 Railroad Avenue Ceres, Ca 95307

Ph: 209.537.4751 Fax: 209.537.5349

www.stuartdavid.com

Stuart David

Home Furnishings

One size does not fit all. That's why Stuart David has created such an extensive Home Office Collection, designed with a variety of sizes and configurations, allowing you to pick the quality pieces that fit your needs the best. With our Home Office program you can create a: straight, wedge, partner, L or U shaped desk with options like: drawers, doors, file drawers, printer pullout shelf, or a space for your computer tower. You don't just get to choose the handmade pieces and configuration either; You also get to choose how they look with custom options like style, solid wood, finish, and hardware. Come visit our 25,000 square foot factory showroom to see the American made difference at Stuart David.



It is All About Choice

Choose How Your Office Will Look

1. Select a Style
2. Select a Wood
3. Select a Finish
4. Select Hardware

Steps for creating the perfect office...

Fine Hardwoods Available

- CHY** - Cherry
- MAP** - Maple
- Oak** - Red Oak
- QS** - Quartersawn
(White Oak)
- AK** - Rustic Alder
- CK** - Rustic Cherry
- HK** - Rustic Hickory
- OK** - Rustic Oak

1. Select a Desk Layout

Straight Desks Pages 3-4	Free-Standing Wedge Desks Page 5	Wedge Desks with Returns Pages 7-9	L-Shaped Desks Page 11
U-Shaped Desks Page 12	Peninsula Desks Page 14	Partners Desks Page 15	Writing Desks Page 22

2. Select Base Units

Base Units & File Cabinets	
 File Cabinets Page 17	 Single & Double Wide Base Units Page 17-18

3. Select Uppers

Uppers		
 48½" Tall	 62" Tall Pages 19-20	 62" Tall, Open

4. Matching Bookcases

Bookcases	
Deluxe Bookcases 30" & 72" Tall Page 25	Library Bookcases 78" & 92" Tall Pages 26-28

5. Select Options

Options Key					
	Size Modification \$		Left or Right Compartment \$		Paneled Back \$
	Paneled Back \$		Pencil Drawer (In Place of Standard Keyboard Drawer) \$		Paneled End \$
	Executive Back \$		Closed Keyboard Tray (In Place of Drawer) \$		Change 1 Door To Glass \$
	Overhang Top \$		1-14 LED Lights \$		Remove 1 Door \$
	Bow Top \$				

R-Options

R-5 22 1/2" Depth 19 1/2" Height 18" Width	R-7 22 1/2" Depth 19 1/2" Height 18" Width
--	--

D-Options

D-2 2 drawers 19 1/2" Height 18" Width	D-3 2 drawers 19 1/2" Height 18" Width	D-4 4 drawers 19 1/2" Height 18" Width
--	--	--

*D2 Option Not Available In D6 Style

Additional Options, See Page 2 of Price List

Select a Style

Classic 2 D2

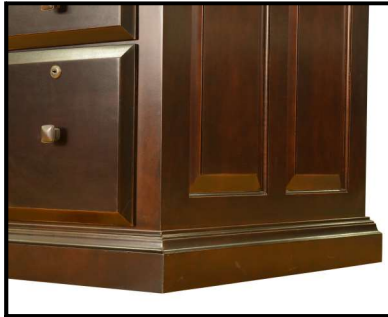
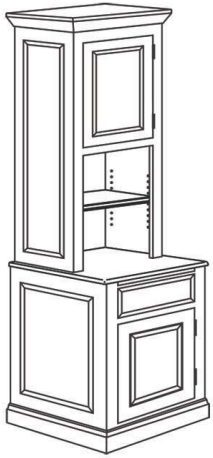

- Base Trim Approx 1" Overhang
- Raised Panels (Doors, Drawers, & Sides)

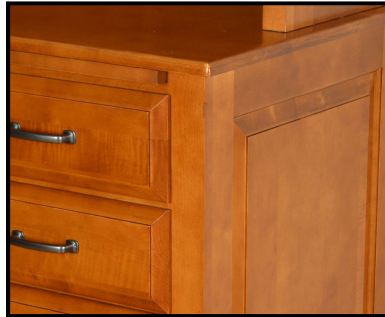

- Top Edge Profile For Desks & Base Units 1/4 Round
- Drawer Profile (Overlay)



- Top Trim Approx 2" Overhang
- Door Profile (Overlay)

For Open Base
Use D1 Style



Craftsman 5 D5

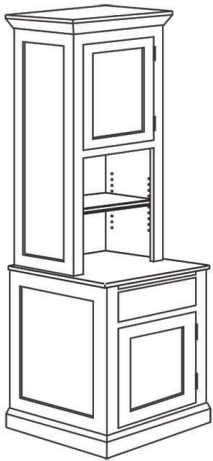

- Base Trim Approx 1" Overhang
- Recessed Panels (Doors, Drawers, & Sides)



- Top Edge Profile For Desks & Base Units Square
- Drawer Profile (Overlay)

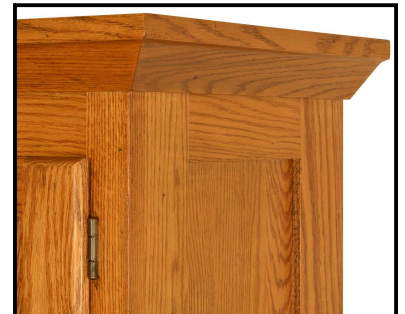

- Top Trim Approx 2" Overhang
- Door Profile (Overlay)

For Open Base
Use D4 Style



Sierra Vista D6

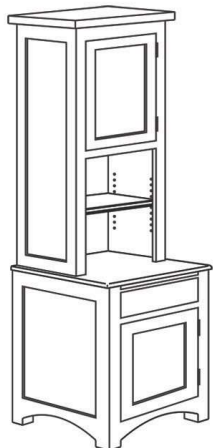

- Base Trim Arch Cut
- Recessed Panels (Doors, Drawers, & Sides)

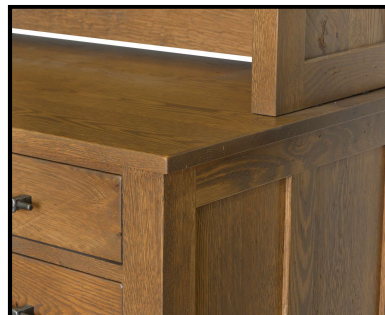

- Top Edge Profile For Desks & Base Units Eased Round
- Drawer Profile (Flush Fitting)



- Top Trim Approx 2" Overhang
- Door Profile (Flush Fitting)

Standard D6 Style is not available in units with 2 or more file drawers (listed below)

Premium Style
Plus 15%

- DN-F12 • DN-F13 • DN-F14 • DN-F23 • DN-F212 • DN-F222 • DN-10(2) • DN-11(2) • DN-242 • DN-342
- DN-024 • DN-24(F) • DN-025 • DN-TL724 • DN-TR724 • DN-TL733 • DN-TR733 • DN-BL71 • DN-BR71

*D2 Option Not Available
In D6 Style

Items above can be custom quoted for D6 style & will add approximately 2" to the height.

Select a Style

Oregon D7

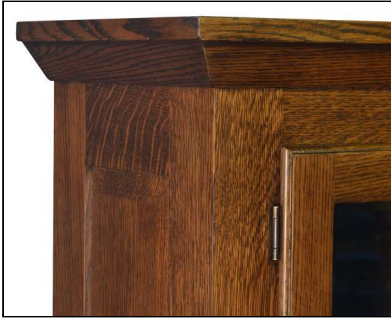

- Top Trim Approx 2" Overhang
- Door Profile (Overlay)



- Top Edge Profile For Desks & Base Units ¼ Round
- Drawer Profile (Overlay)



- Base Trim Wedge Cut
- Raised Panels (Doors, Drawers, & Sides)

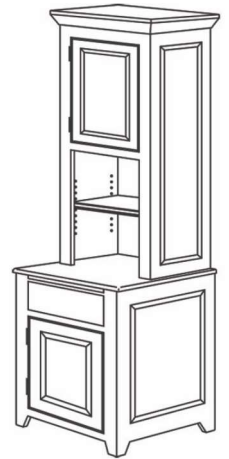

- Top Trim Approx 2½" Overhang
- Door Profile (Overlay)



- Top Edge Profile For Desks & Base Units ¼ Round
- Drawer Profile (Overlay)



- Base Trim Approx 1" Overhang
- Raised Panels (Doors, Drawers, & Sides)

Generations 9 D9

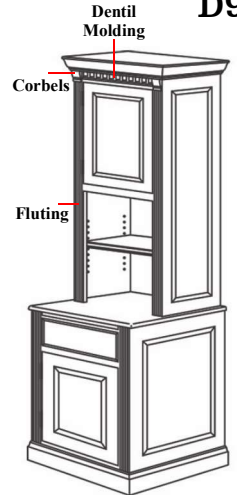

Corbels, Fluted & Dentil Moldings

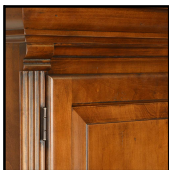

For No Dentil Molding
← Use D8 Style



- Top Trim Approx 2½" Overhang
- Door Profile (Overlay)

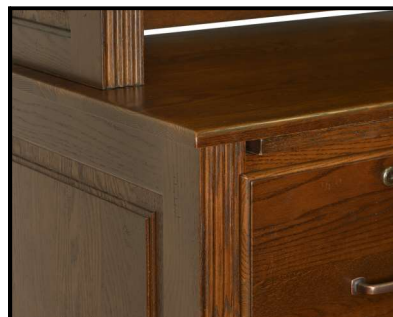

- Top Edge Profile For Desks & Base Units ¼ Round
- Drawer Profile (Overlay)



- Base Trim Approx 1" Overhang
- Specialty Raised Panels (Doors, Drawers, & Sides)

Madison 4 DM

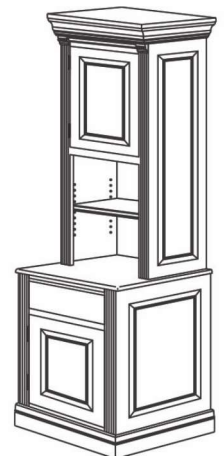

Corbels & Fluting

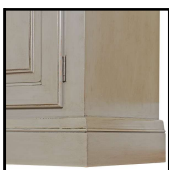

For No Fluting
No Corbels
← Use DN Style

Quality You Can Trust, Craftsmanship That Will Last!

Straight Desks

Width sizes listed are overall
(Including return trims & overhangs)

All items are available as shown or flush one or both sides.

Standard depth size is 22³/₄"

Unless otherwise stated in **RED**

Standard file drawers fit 8¹/₂ x 11

With rods running front to back



Options Key

- Size Modification
- Paneled Back
- Paneled Back
- Executive Back
- Overhang Top
- Bow Top
- Standard Keyboard Tray
- Closed Keyboard Tray
- Pencil Drawer

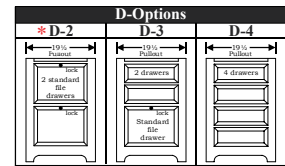
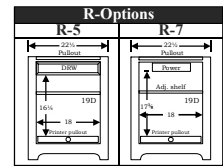

*D2 Option Not Available In D6 Style
Pages 3-5

34³/₄" Wide

Pg. 9

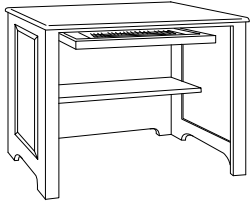

DN-D14K

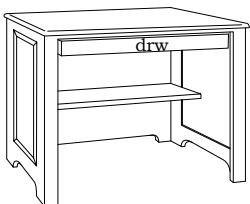

DN-D14D



44³/₄" Wide

Pg. 18

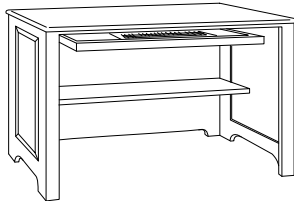

DN-D19K

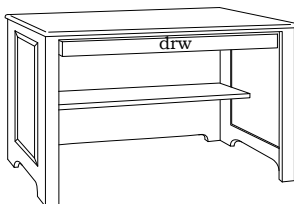

DN-D19D

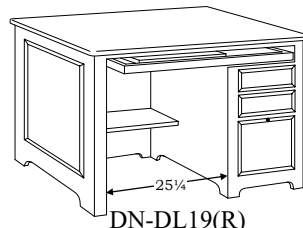

DN-DL19(R)

- Drawers on right (shown)
- Drawers on left (reversed)

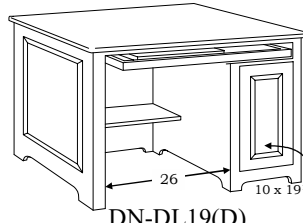

DN-DL19(D)

- Drawers on right (shown)
- Drawers on left (reversed)



52" Wide

Pg. 21

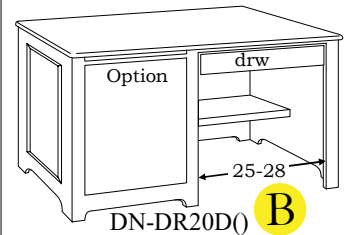

DN-DR20D() **B**

- Option on left (shown)
- Option on right (reversed)

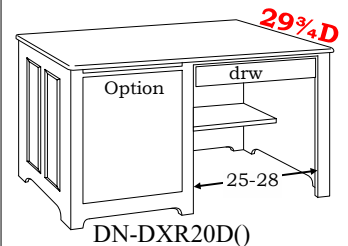

DN-DXR20D()

- Option on left (shown)
- Option on right (reversed)



Straight Desks

62 1/4" Wide Pg. 24-25

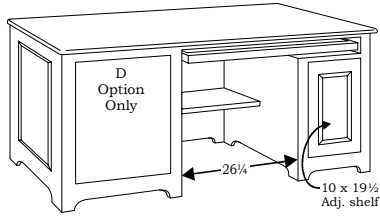

DN-DR22D()

- Option on left (shown)
- Option on right (reversed)

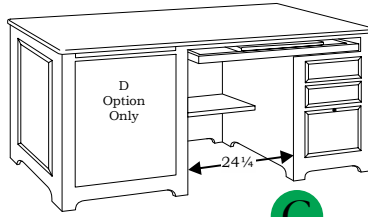

DN-DR22R() **C**

- Option on left (shown)
- Option on right (reversed)

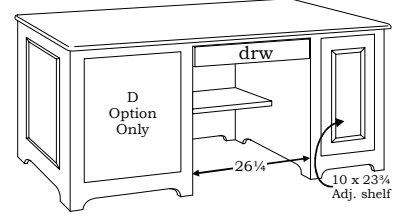

DN-DR122D()

- Option on left (shown)
- Option on right (reversed)

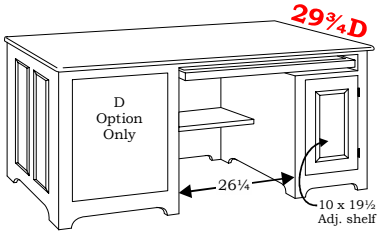
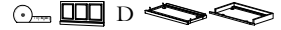

DN-DXR22D()

- Option on left (shown)
- Option on right (reversed)

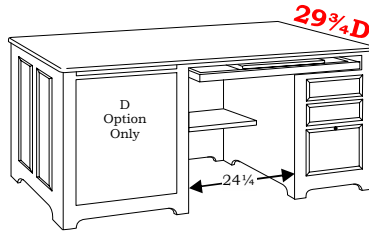

DN-DXR22R()

- Option on left (shown)
- Option on right (reversed)

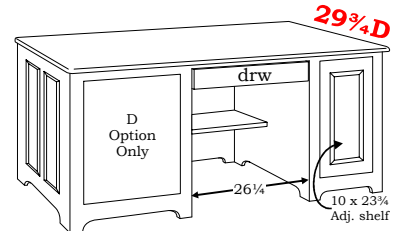

DN-DXR122D()

- Option on left (shown)
- Option on right (reversed)

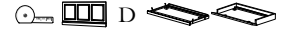

66", 71" & 79 1/2" Wide Pg. 27, 28, 31, 32, 37, 38

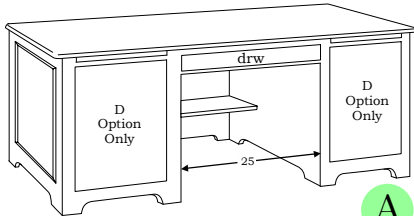

66" w - DN-D23D() **A**

R-Options not Available at 66" Wide.

71" w - DN-D24D()

79 1/2" w - DN-D25D()

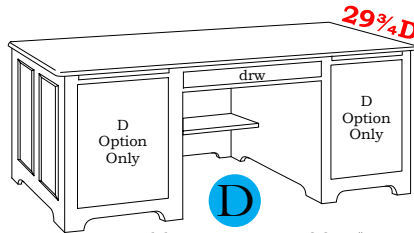

66" w - DN-DX23D() **D**

R-Options not Available at 66" Wide.

71" w - DN-DX24D()

79 1/2" w - DN-DX25D()



(Shown in D2 Style with #2 Option Left & #3 Right)



(Shown in D8 Style with #3 Option Left)



(Shown in D2 Style with #4 Option Left & #3 Right)



(Shown in D2 Style with #3 Option Left)

Wedge Desks



DN-GL24K()
 (Shown in D1 Style with #3 Option)

66" Wide
 Pg. 29

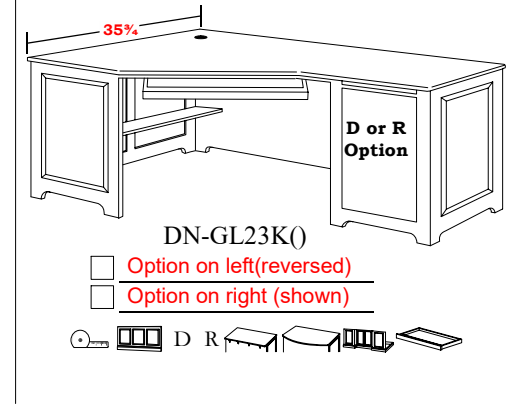

UN-25A(GO)
DN-GL25()
 (Shown in D8 Style with #3 Option Left & #7 Right)

79 1/2" Wide
 Pg. 39

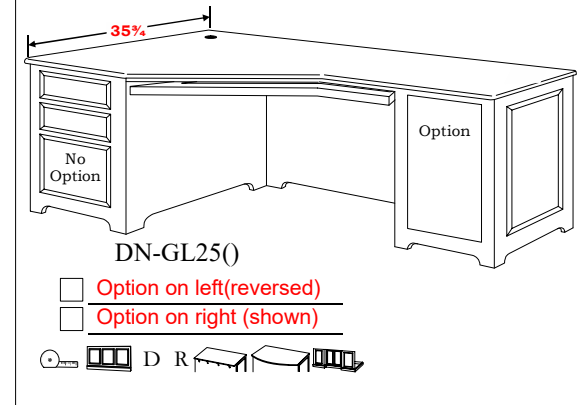

Wedge Desks with Returns



Quality You Can Trust, Craftsmanship That Will Last!

Wedge Desks with Returns

66" Wide

Pg. 42

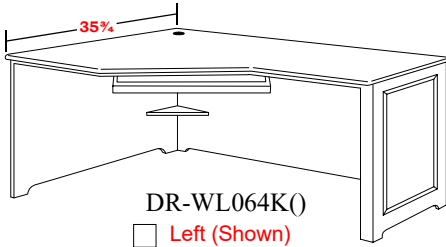

DR-WL064K()

- Left (Shown)
- Right (Reversed)

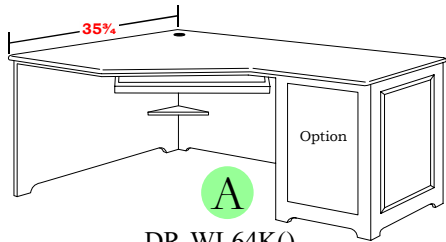

DR-WL64K()

- Option on Left (Shown)
- Option on Right (Reversed)

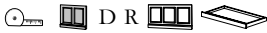

79 1/2" Wide

Pg. 43

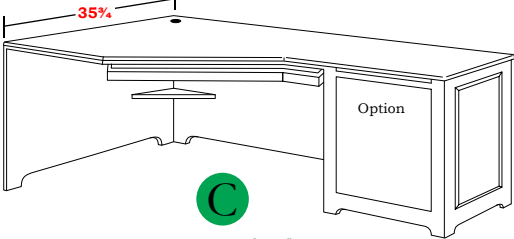

DR-WL78K()

- Option on Left (Reversed)
- Option on Right (Shown)

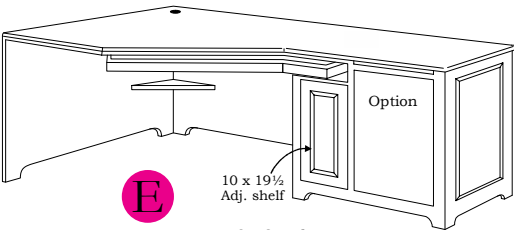

DR-WL278K()

- Option on Left (Reversed)
- Option on Right (Shown)



Standard depth size is 22 3/4" unless otherwise stated in Red

Standard file drawers fit 8 1/2 x 11 with rods running front to back

Options Key

	Size Modification		1-14 LED Lights		LED Light Standard
	Paneled Back		Paneled Back		
	Paneled End		Pencil Drawer		
	Overhang Top		Wood Door Option		
	Bow Top		Glass Door Option		
	Left or Right Compartment		Remove 1 Door		

R-Options

D-Options

Pages 7-9

*D2 Option Not Available In D6 Style



(Shown in D2 Style with #2 Option Left & #3 Option Right)



(Shown in D2 Style with #5 Option Left & #3 Option Right)



(Shown in D8 Style with #5 Option Left)

American Made Solid Wood Furniture

Returns for Wedge Desks

Return Orientations

Returns are Available Reversed as Shown

Left

Right

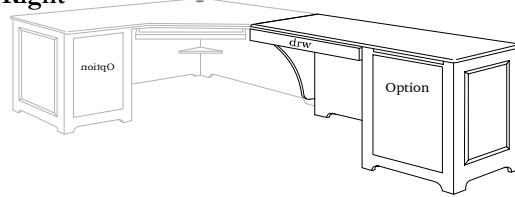
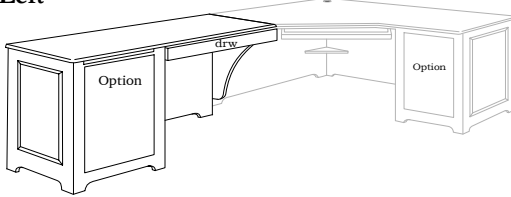

30 1/4" Wide

Pg. 44-45

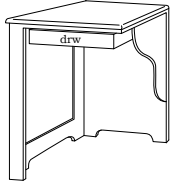

DN-TL711

- Left (Shown)
- Right (Reversed)

D R

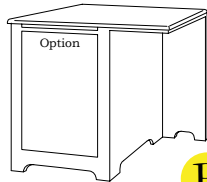

DN-TL712() **B**

- Option on left (shown)
- Option on right (reversed)

D R



DN-TL712()

(Shown in D2 Style with #2 Option)

35 1/4" Wide

Pg. 44-45

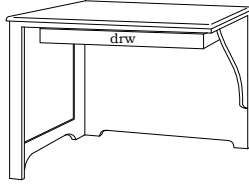

DN-TL721

- Left (Shown)
- Right (Reversed)

D R

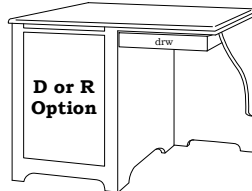

DN-TL722()

- Option on left (shown)
- Option on right (reversed)

D R

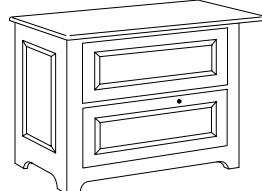

DN-TL724

- Option on left (shown)
- Option on right (reversed)

D R

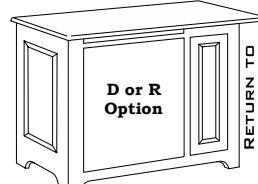

DN-TL723()

- Option on left (Shown)
- Option on right (Reversed)

D R

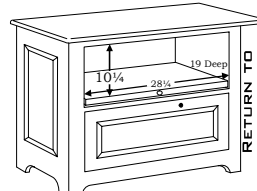

DN-TL725

- Drawers on left (shown)
- Drawers on right (reversed)

D R

51 1/2" Wide

Pg. 44-45

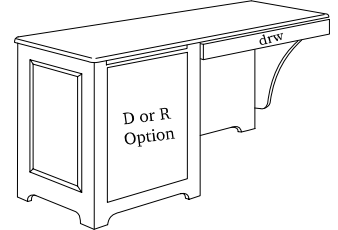

DN-TL731()

- Option on left (Shown)
- Option on right (Reversed)

D R

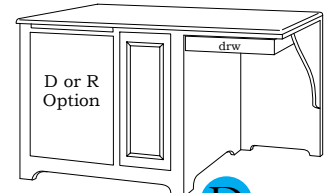

DN-TL732() **D**

- Option on left (Shown)
- Option on right (Reversed)

D R

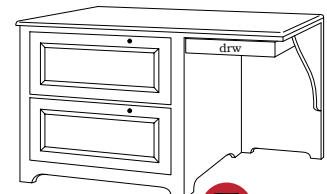

DN-TL733() **F**

- Drawers on left (shown)
- Drawers on right (reversed)

D R

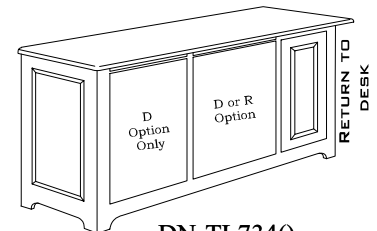

DN-TL734()

- Doors on left (shown)
- Doors on right (reversed)

D R



DN-TL731()

(Shown in D9 Style with #3 Option)



DN-TL733()

(Shown in D9 Style)

Quality You Can Trust, Craftsmanship That Will Last!

Layouts for Desks with Returns

For Desks with 30¹/₄" - 35¹/₄" Wide Returns

Pg. 46-48

48¹/₂" & 62" Tall

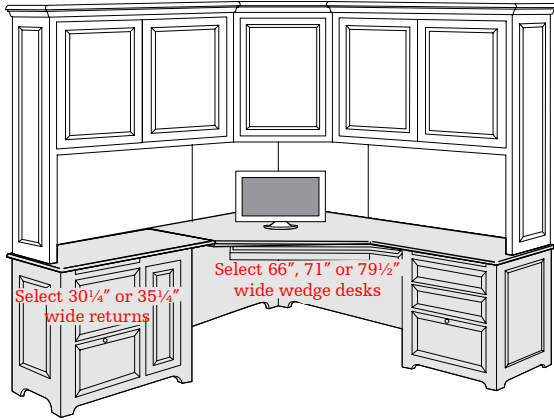

62" Tall Only

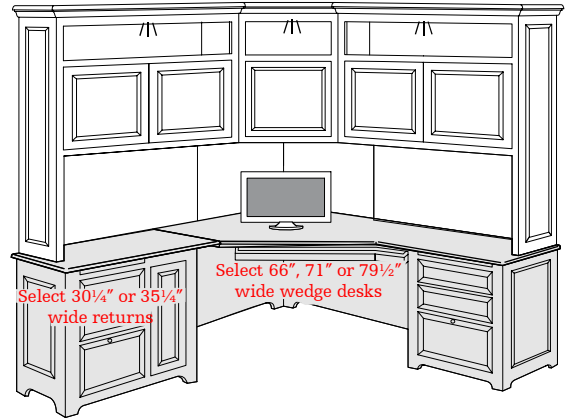

For Desks with 50¹/₂" Wide Returns

Pg. 46-48

48¹/₂" & 62" Tall

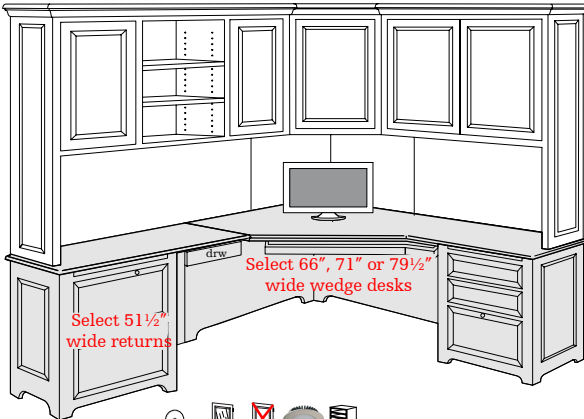

62" Tall Only

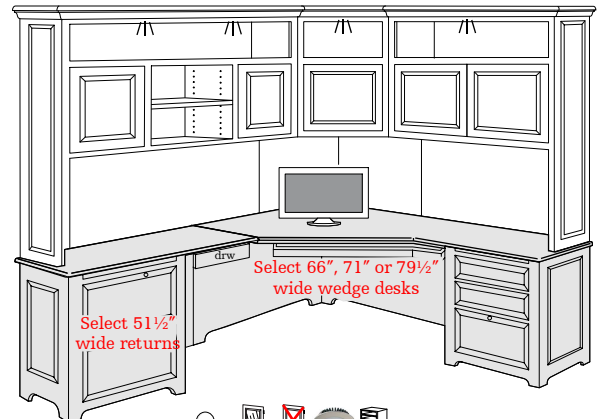

For Desk Returns up to 97" Wide

Pg. 49

48¹/₂" & 62" Tall Only

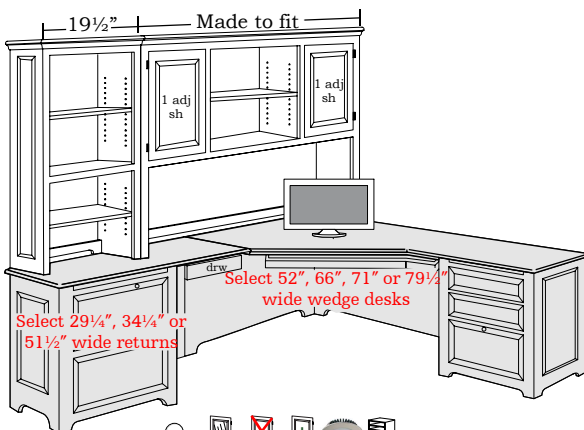

62" Tall Only

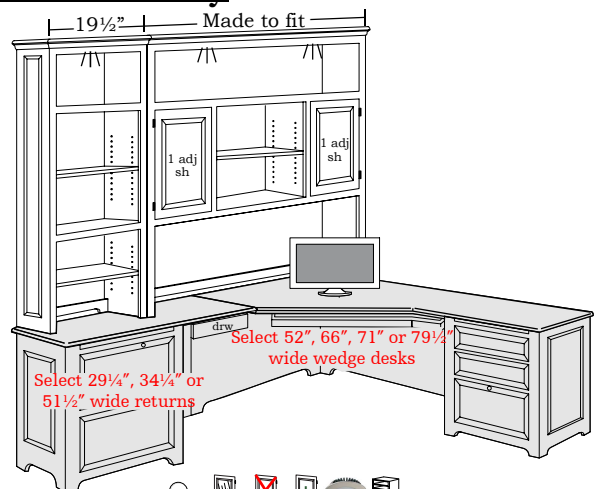

American Made Solid Wood Furniture

L Shaped Desks & Returns



Quality You Can Trust, Craftsmanship That Will Last!

L Shaped Desks & Returns

Standard depth size is **22³/₄"**
 Unless otherwise stated in **Red**
 Standard file drawers fit **8¹/₂ x 11**
 With rods running front to back

Options Key

	R-Options	
	R-5	R-7

	D-Options		
	D-2	D-3	D-4

***D2 Option Not Available In D6 Style** Page 11

48" & 62" Tall Upper

Pg. 49

Made to fit 19¹/₂"

1 adj sh

1 adj sh

Select 29¹/₄", 34¹/₄" or 51¹/₂" wide returns

Select 52", 66", 71" or 79¹/₂" wide wedge desks

62" Tall Upper Only

Pg. 49

Made to fit 19¹/₂"

1 adj sh

1 adj sh

Select 29¹/₄", 34¹/₄" or 51¹/₂" wide returns

Select 52", 66", 71" or 79¹/₂" wide wedge desks

48¹/₄" Wide Returns 71" & 79¹/₂" Wide Desks

Pg. 52

Pg. 50-51

DN-YL75K

Left (Shown)

Right (Reversed)

DN-YL75D

Left (Shown)

Right (Reversed)

71"w- DR-QL69D()

79¹/₂"w- DR-QL78D()

Keyboard on left (reversed)

Keyboard on right (shown)

71"w- DR-QL269D()

79¹/₂"w- DR-QL278D()

Drawer on left (shown)

Drawer on right (reversed)

DN-YL74D()

Option on left (shown)

Option on right (reversed)

DN-YL74K()

Option on left (shown)

Option on right (reversed)

58³/₄" Wide Returns

Pg. 52

DN-YL76K()

Option on left (shown)

Option on right (reversed)

DN-YL77D()

Option on left (shown)

Option on right (reversed)

U-Shaped Desks



Options Key	
	Size Modification
	Paneled Back
	Closed Keyboard Tray
D-Options	
* D-2 2 standard drawers 19 1/2" Pullout	D-3 2 drawers 19 1/2" Standard drawer
	D-4 4 drawers 19 1/2" Pullout

***D2 Option Not Available In D6 Style Page 12**

64³/₄" & 70³/₄" Wide
Pg. 13

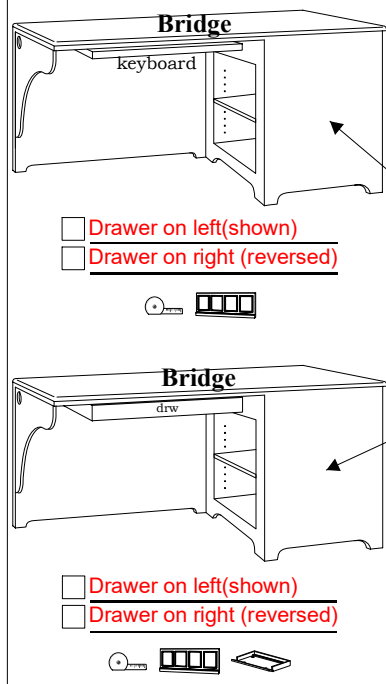

Note:
Any **23³/₄"** Deep
Base Unit Can Be
Used With Bridge

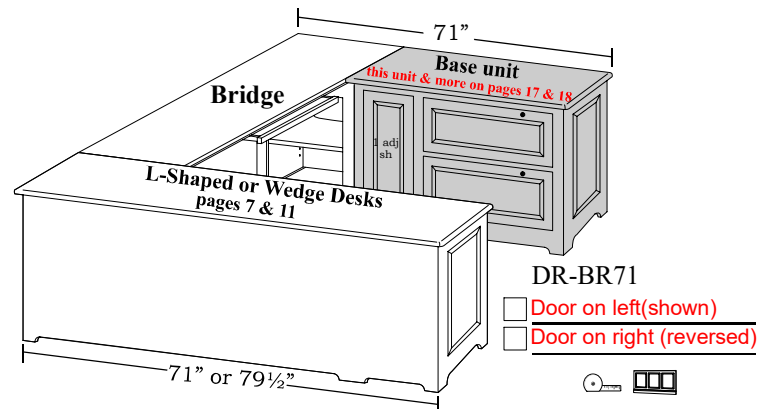
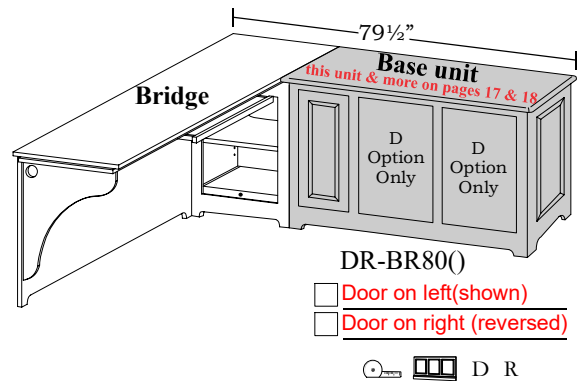

Peninsula and Partners Desks



Peninsula Desks

Standard depth size is **22³/₄"**
 Unless otherwise stated in **Red**
 Standard file drawers fit **8¹/₂ x 11**
 With rods running front to back

59¹/₂" Wide Desk

Available reversed Pg. 6

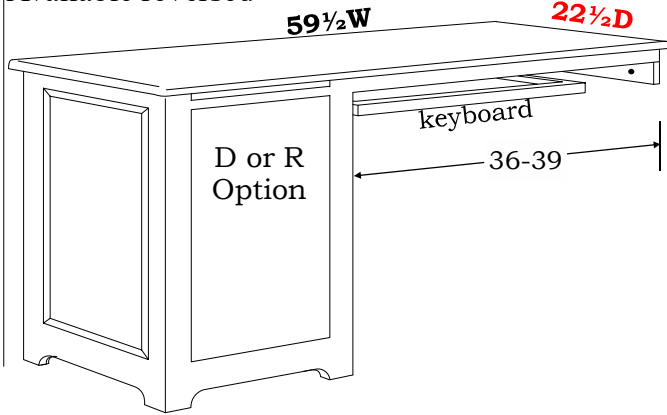

- DN-ML160K
- Option on left (shown)
 - Option on right (reversed)
- D R

24¹/₂" Wide Desk Mate

Pg. 6

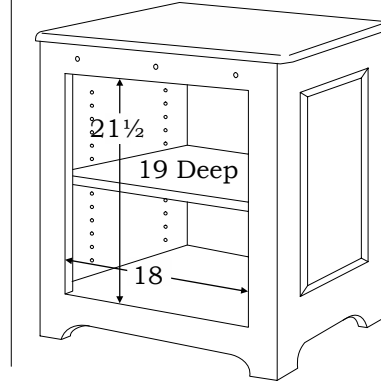

DN-M11(O)

Options Key

- Size Modification
- Paneled Back
- Pencil Drawer
- Closed Keyboard Tray

R-Options

R-5	R-7

D-Options

*D-2	D-3	D-4

***D2 Option Not Available In D6 Style Page 14**

59¹/₂" Wide Desk

Available reversed Pg. 10

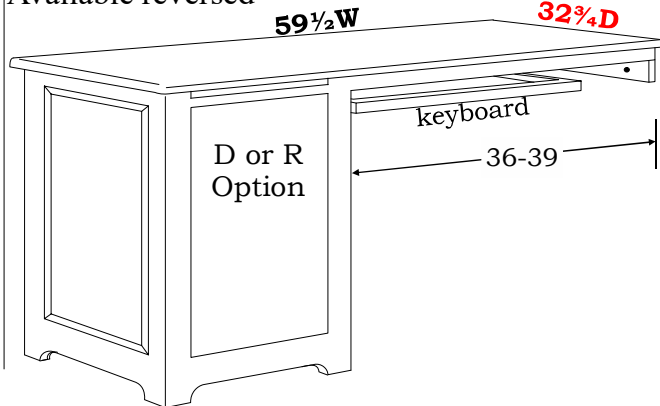

- DN-ML260K
- Option on left (shown)
 - Option on right (reversed)
- D R

34³/₄" Wide Desk Mate

Pg. 10

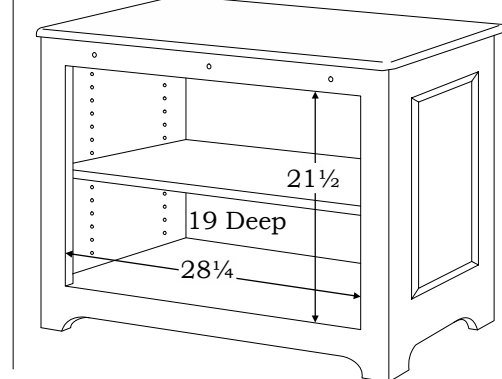

DN-M14(O)

Partners Desks

58" Wide Desk

Pg. 13

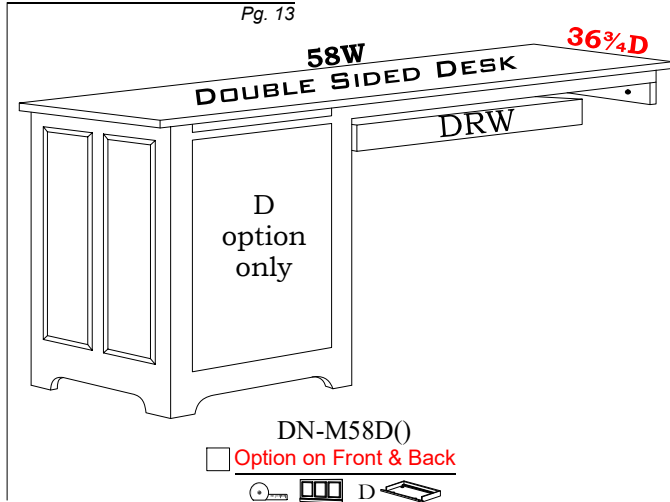

DN-M58D()

Option on Front & Back



38 3/4" Wide Desk Mate

Pg. 13

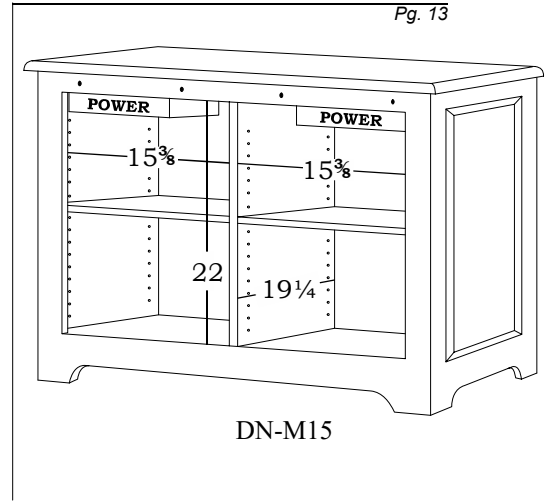

DN-M15

Standard depth size is **22 3/4"**

Unless otherwise stated in **Red**

Standard file drawers fit **8 1/2 x 11**

With rods running front to back

Options Key

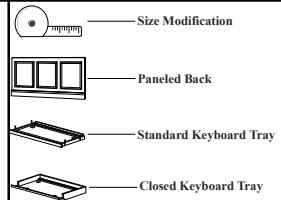

D-Options

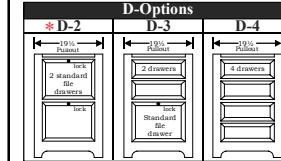

***D2 Option Not Available In D6 Style Page 15**

65" Wide Desk

Pg. 13

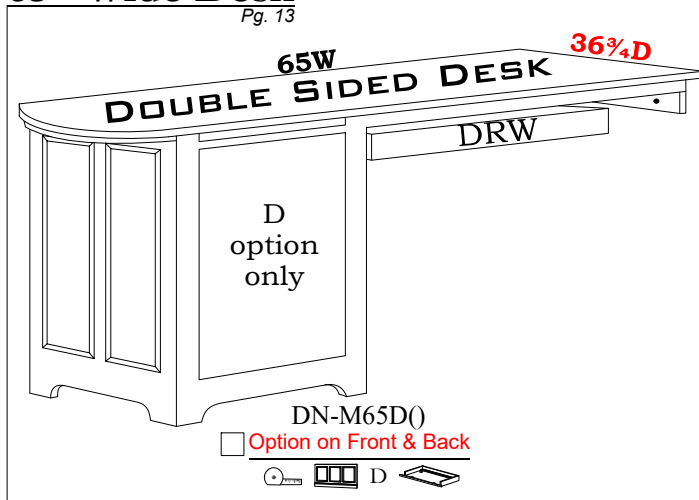

DN-M65D()

Option on Front & Back



American Made Solid Wood Furniture

Base Units, File Cabinets & Computer Stations



A

(Shown in D2 Style)



B

(Shown in D4 Style)



C

DN-342
(Shown in D2 Style)



D

DN-24(F)
(Shown in D4 Style)

Quality You Can Trust, Craftsmanship That Will Last

Base Units & File Cabinets

21½" Wide Pg. 3

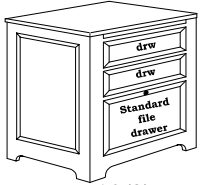

DN-10(3)

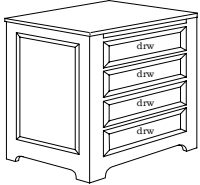

DN-10(4)

21½" & 24½" Wide Pg. 3 & 5



21½"w - DN-10(O)
24½"w - DN-11(O)

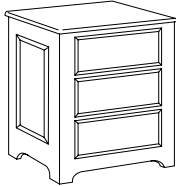

21½"w - DN-10(R)
24½"w - DN-11(R)

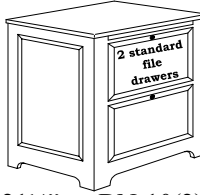

21½"w - DN-10(2)
24½"w - DN-11(2)

For DN-11(2) Only
Accepts 8½ x 11 or 8½ x 14

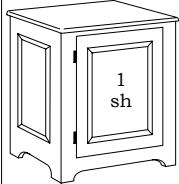

21½"w - DN-10(D)
24½"w - DN-11(D)

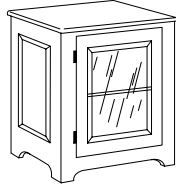

21½"w - DN-10(G)
24½"w - DN-11(G)

24½" Wide Pg. 5

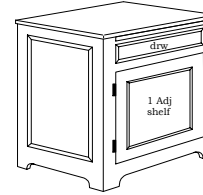

DN-11(5)

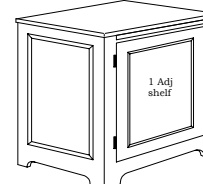
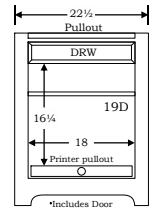

DN-11(7)

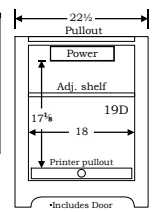

34¾" Wide Pg. 9

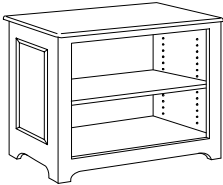

DN-14(O)

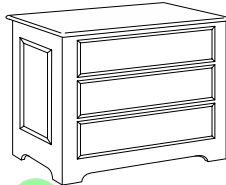

A DN-14(R)

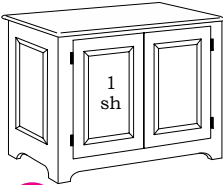

E DN-14(D)

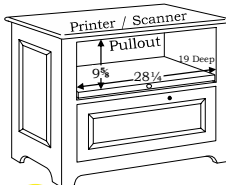

B DN-232

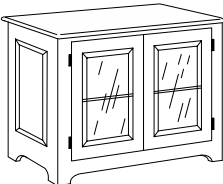

DN-14(G)

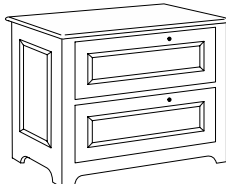

DN-242

40¾" Wide Pg. 15

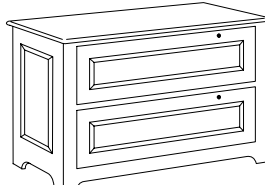

C DN-342

For DN-342 Only
Accepts 8½ x 11 or 8½ x 14

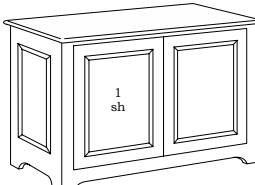

DN-26(D)

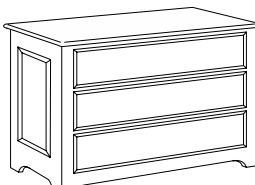

DN-26(R)



E

(Shown in DM Style)

Standard depth size is **22¾"**
Unless otherwise stated in **Red**

Standard file drawers fit **8½ x 11**
With rods running front to back

Options Key					
	Size Modification		Paneled Back		Paneled Back
	D-Options		R-Options		
*D-2	D-3	D-4	R-5	R-7	
*D2 Option Not Available In D6 Style					
Pages 17-19					

Base Units, File Cabinets & Computer Stations

40³/₄" Wide

Computer Stations

With Keyboard & Printer Pullouts Pg. 15

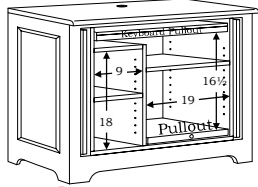

F DN-952

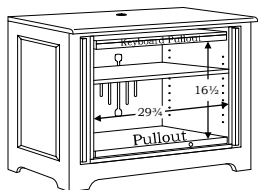

DN-953

44³/₄" Wide

Pg. 18

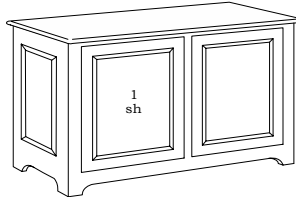

DN-19(D)

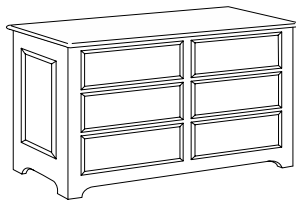

DN-19(R)

71" Wide

Pg. 33

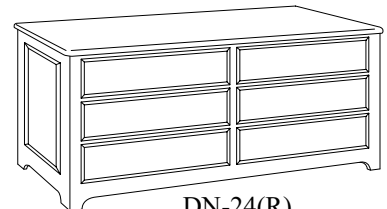

DN-24(R)

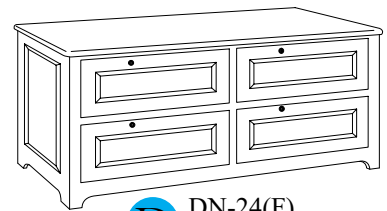

D DN-24(F)

71" Wide

Pg. 33

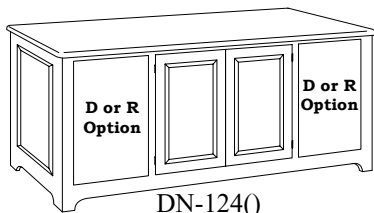

DN-124()
D R



G DN-924(DO)

71" & 79¹/₂" Wide

Pg. 33 & 38

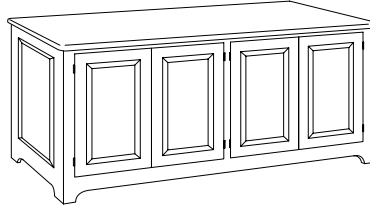

DN-25(D)
DN-24(D)

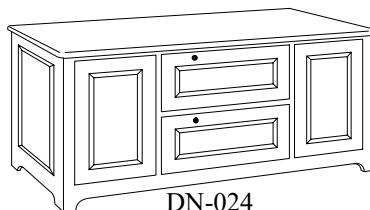

DN-024
DN-025



F
(Shown in D1 Style)

The Home Office Program Can Be Used In Conjunction With The Home Entertainment Program

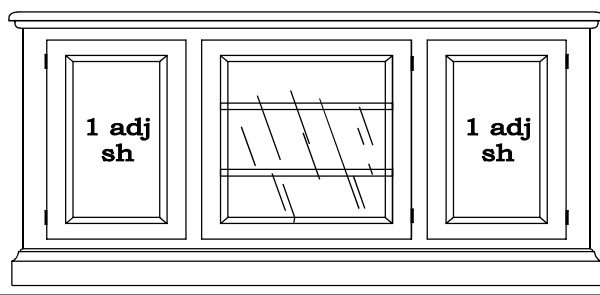

G
(Shown in D8 Style)

Quality You Can Trust, Craftsmanship That Will Last!

Uppers For Desks & Base Units

21½" - 24½" Wide

Pg. 4, 7 & 8

48½" & 62" Tall

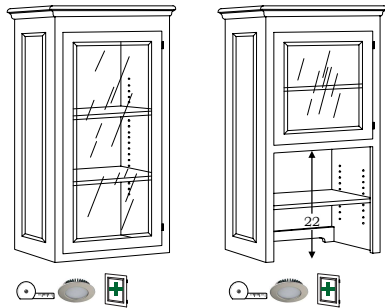
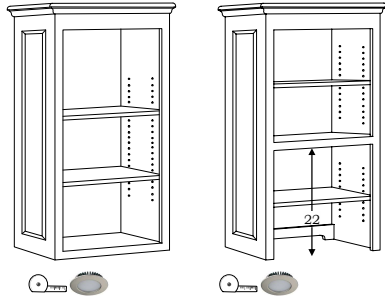

62" Tall Only

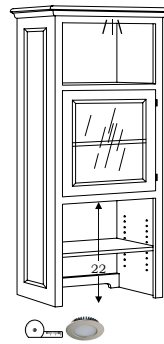
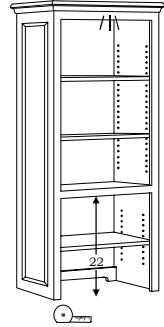

34¾" - 40¾" Wide

Pg. 11, 12, 14, 16, & 17

48½" & 62" Tall

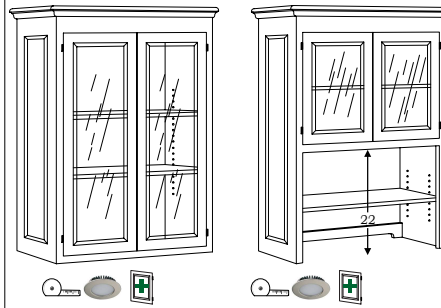
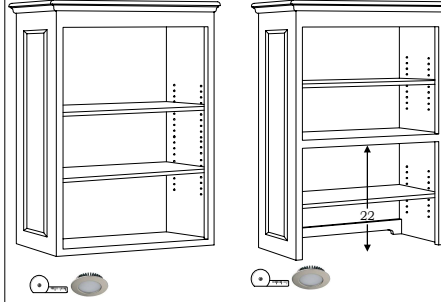

62" Tall Only

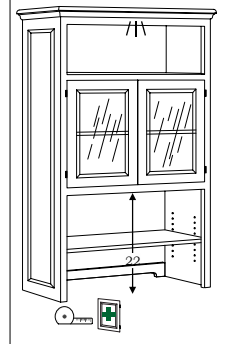
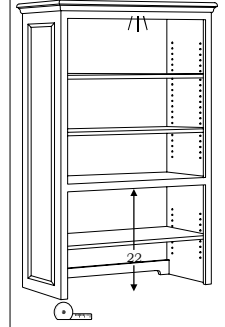

44¾" - 52" Wide

Pg. 19, 20 & 23

48½" & 62" Tall

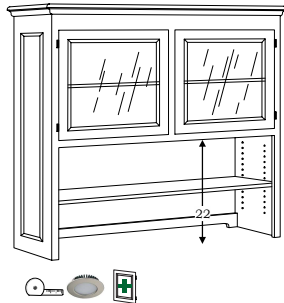
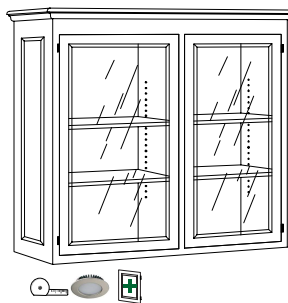
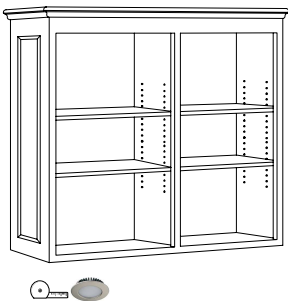

62" Tall Only

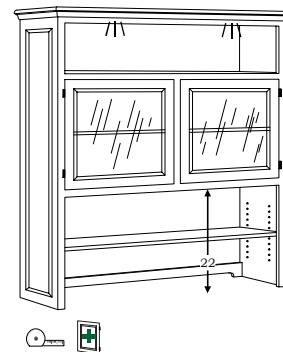
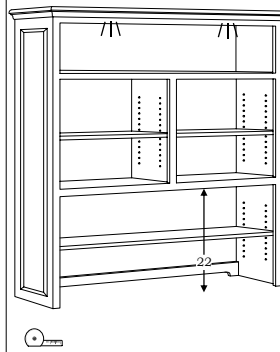

Options Key

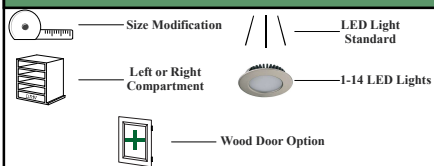

Pages 21-22

American Made Solid Wood Furniture

Uppers For Desks & Base Units

52" Wide
Pg. 22

48½" Tall Only

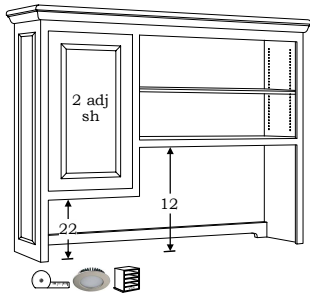

- Door on Left (Shown)
- Door on Right (Reversed)

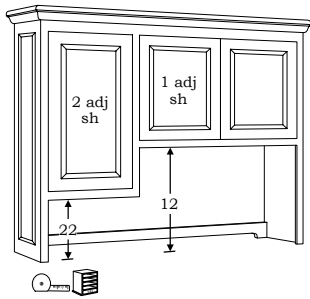

- Large Door on Left (Shown)
- Large Door on Right (Reversed)

33¼" Tall Only

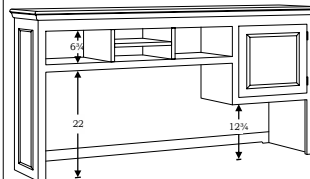

- Door on Left (Reversed)
- Door on Right (Shown)

62¼" Wide
Pg. 26

48½" Tall Only

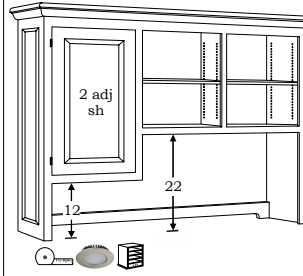

- Door on Left (Shown)
- Door on Right (Reversed)

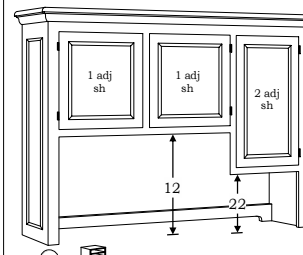

- Large Door on Left (Shown)
- Large Door on Right (Reversed)

62¼" Wide To 79½" Wide
Pg. 26, 30, 34, 40

48½" & 62" Tall

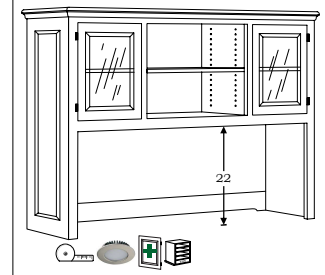

62" Tall Only

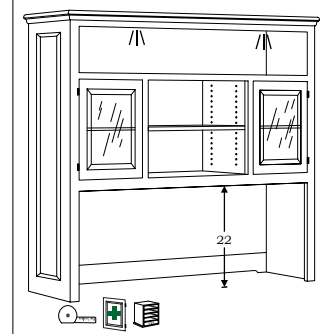

71" Wide
Pg. 36

48½" & 62" Tall

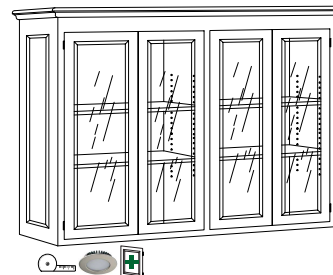
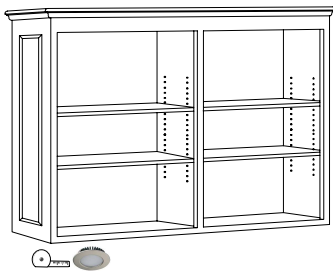

71" Wide & 79½" Wide
Pg. 35 & 41

48½" & 62" Tall

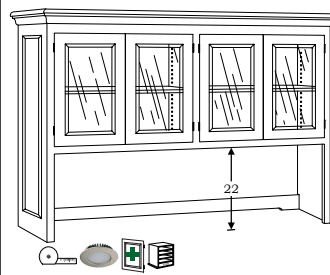
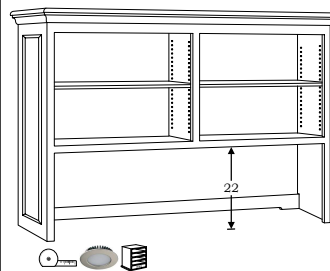

66" Wide & 71" Wide
Pg. 30 & 34

48½" Tall

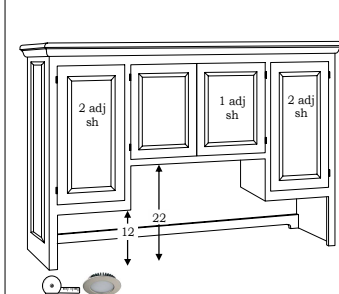
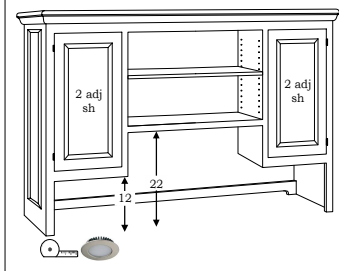

File Cabinets

For additional file cabinets see pages 17 & 18

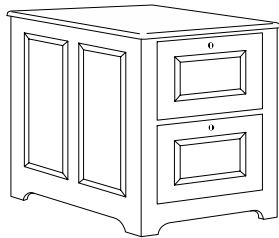

DN-F12
24"W x 25½"D x 29½"H

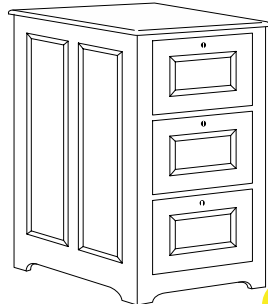

DN-F13 **B**
24"W x 25½"D x 41¾"H

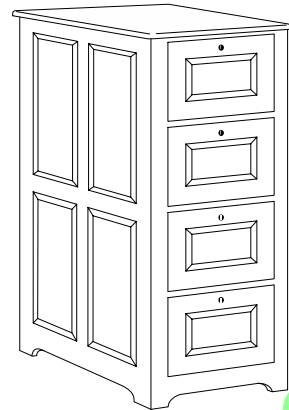

DN-F14 **A**
24"W x 25½"D x 54"H

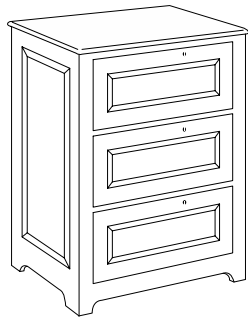

DN-F23
34¾"W x 22¾"D x 41¾"H

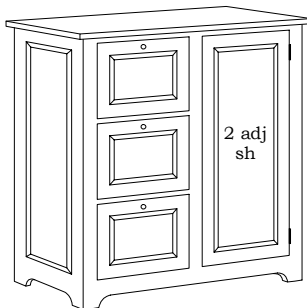

DN-F212
38¾"W x 22¾"D x 41¾"H



DN-F222 **C**
38¾"W x 22¾"D x 41¾"H



A
(Shown in D2 Style)



B
(Shown in D5 Style)



C
(Shown in D2 Style)

American Made Solid Wood Furniture